



INDEX

01	THE DESIGN & LIFESTYLE ON BOARD	P04
02	HER MAIN TECHNICAL FEATURES	P42
03	GRANDE 36M SPEC SHEET	P47
04	THE GRANDE SERIES	P54
05	ABOUT AZIMUT	P56



A one-of-a-kind beauty, enrapturing,
that steals your breath away, leaving you
speechless. An extraordinary idea as the only
possible pathway, to get to where you want,
to explore, to go beyond.

The freedom of embracing the unknown, that
you know you'll love as a part of your very own
story. A thought that provokes your mind and
then inspires you to aim for the impossible,
making mistakes, yet being brave.

A magic je ne sais quoi that enchants and
intrigues you, moving you to feel more and to
sense uniqueness.

The choice to risk it all, the one that makes you
go for it, to impress yourself and all those who
are worth it.

Welcome to Azimut.

AZIMUT.
DARE TO AMAZE.



01

THE DESIGN & LIFESTYLE ON BOARD

GRANDE 36M, AN OPEN SEA EXPERIENCE

With her original design and modern ethos, the Azimut Grande 36M is a superyacht that synthesizes cutting-edge style and attitude. From the unprecedented semi-walkaround upper deck inspiring freedom of movement to the fully retractable side windows posing a special gateway to the sea, all elements contribute to visually blend interior and exterior spaces. A barrierless lifestyle naturally blurs the boundaries between onboard pleasure and oceanic greatness.

Free your sea soul with the Grande 36M.



[The Grande 36M bears unexpectedly expansive glazed surfaces for a feeling of lightness inside and out.]



[Following the design cues from the Trideck, the Grade 36M is built on horizontal architecture with an enhanced perception of length.]

Welcome aboard, ladies and gentlemen.

Let us begin the tour.



SHE EXPRESSES STATE-OF-THE-ART MODERNITY





Designed by the skilled hand of Alberto Mancini, the Grande 36M is instantly recognizable by her elongated lines and clean surfaces. The exterior design matches the superyacht's substantial size with a sportive stance, aided in breaking up the volumes by the sculpture of the hull sides.

INFINITY SKYDECK, FLUSH FROM STERN TO BOW

With the Grande 36M, Azimut introduces the first semi-walkaround upper deck that runs flush from the stern to almost the extreme bow, offering unprecedented freedom of movement. The side windows are fully retractable, joining the skylounge with the aft terrace to create an immense barrierless area. Wrapping around to the bow, we come to a whirlpool tub made entirely of glass and a sunbathing area equipped with every comfort.



THE FREEDOM TO CHOOSE



Striving to realize her owner's dreams, the Grande 36M proposes unprecedented personalization at every level. Even the number of levels may be configured to have a sleek coupe or a sundeck as the cherry on top.



[The walls of the skylounge are made of glass and may be retracted with the push of a button, offering a rare combination of marine immersion and cosiness, while unifying the Infinity Skydeck into a single free-flowing floor.]

LAID OUT FOR LIFESTYLES



The size of the skylounge gives the freedom to appoint it according to the owner's lifestyle. Aside from the lounge cinema setup, it may be configured as the main indoor dining, therefore freeing up the fore part of the main deck to host a second, more secluded spot, named the Gentleman's Club.



A SPECTRUM OF SHELTER

The informal seating arrangement closest the skylounge is protected on the sides and from above, creating a recessed retreat from which to enjoy the fresh air without wind or weather.

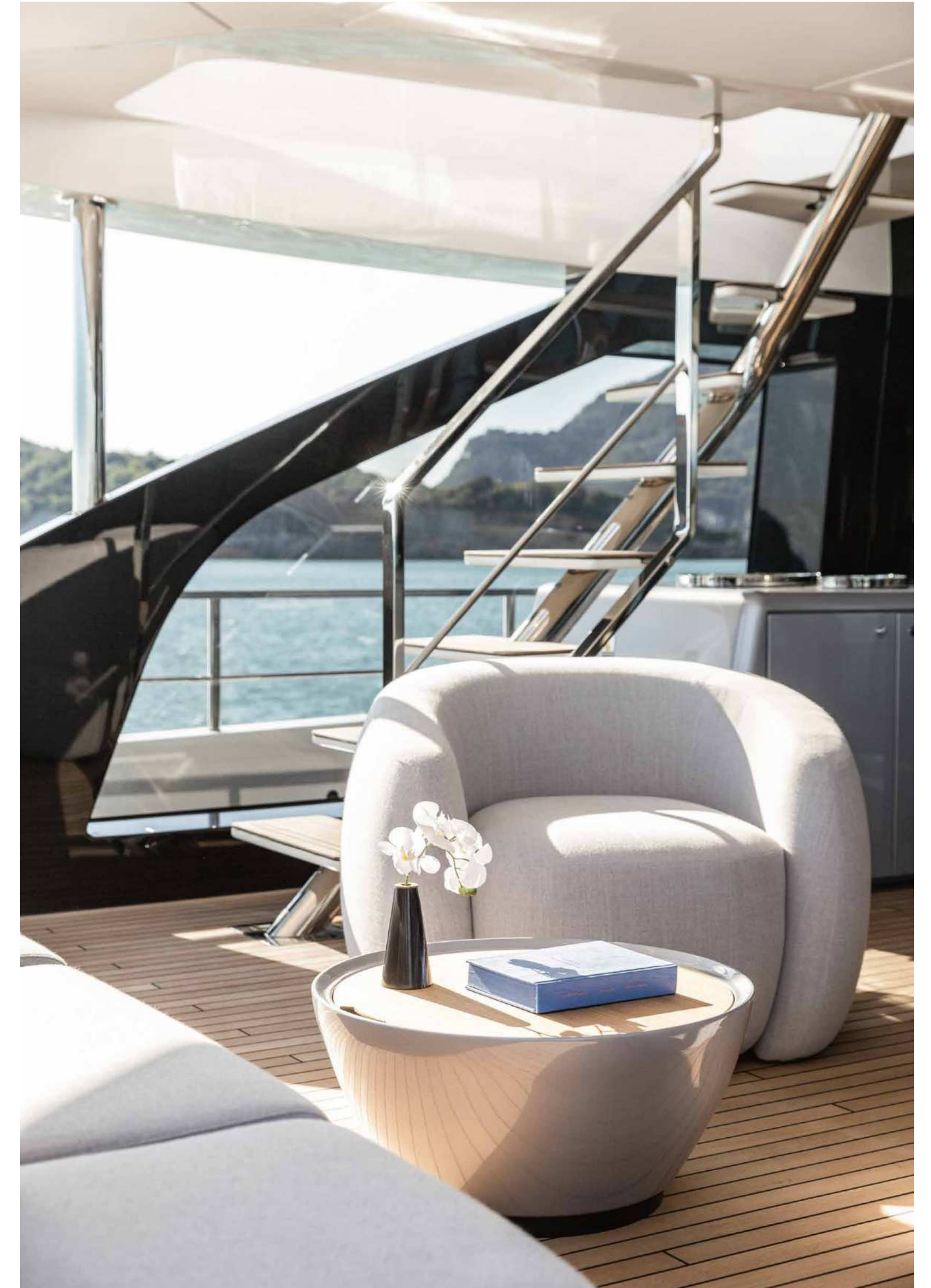







KEEP YOUR FRIENDS CLOSE AND THE SEA CLOSER

With the tender and toys stored in a side garage, the Grande 36M dedicates the entire waterfront to relaxation. The transom platform folds down, simultaneously creating an substantial beach and revealing an amply appointed beach club, to offer unexpected comfort and closeness to the sea.





GRANDE 36M



AZIMUT YACHTS



The sundeck is particular among the outdoor spaces, offering every essential for hosting in an intimate setting, secluded by its altitude.



[The elevated panorama of the sundeck seems suspended in time, as well as the air.]

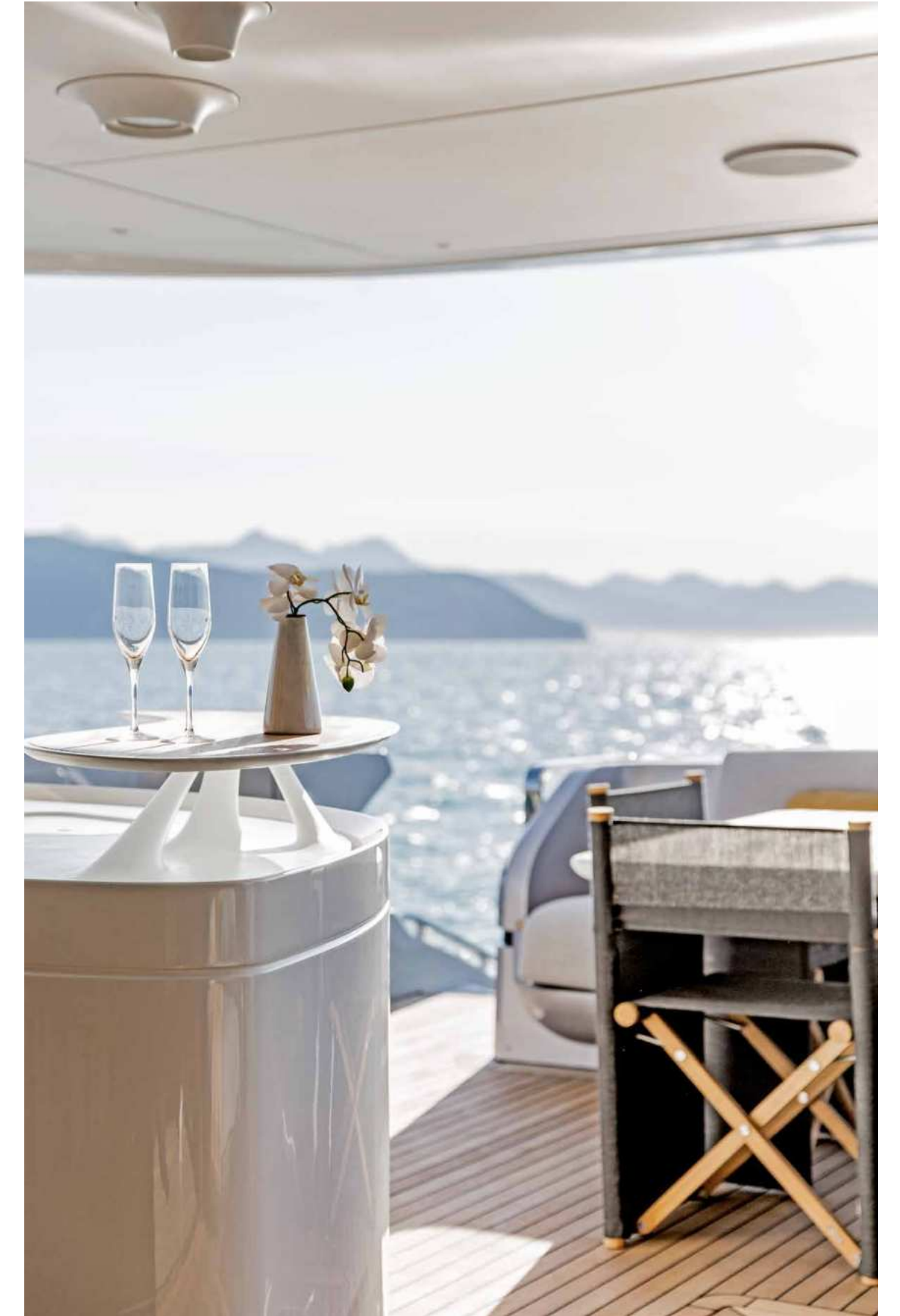

The cockpit blends the beach area together with the main deck, with sheltered, open air dining and an American bar.

A WELL-ROUNDED LOUNGE

The circular lounging island at the entry of the main deck proves that space is a luxury, taking thoughtful advantage of the furniture arrangement to provide clear views through full-height windows and separate pathways on either side; one for the guests and one for the crew.





[The flood of natural light pouring into the salon creates an unexpected visual effect, revealing subtle design elements and energizing the ambience.]



GRANDE 36M



AZIMUT YACHTS

AN INTEGRATED DINING EXPERIENCE

Between the 270-degree view onto the sea and the sculpted galley bulkhead, which artfully imitates waves, the dining arrangement observes nautical tradition with radical openness.





GRANDE 36M



AZIMUT YACHTS

Now, let us discover the guest accommodations.

Shall we?



A SANCTUARY OF LIGHT





The centrally set king-sized bed allows free movement throughout the main chamber, which is flanked by furniture arrangements. Behind the head of the bed, the entire bulkhead is dedicated to full-height wardrobes and a mirrored dressing area.





[Minimalist design and LED underlighting gives an impression of floating furniture and weightlessness.]



GRANDE 36M



AZIMUT YACHTS

YOUR PRIVATE SPA

The forward washroom extends to the glass-walled shower, opening up a refreshing annex with stone and reflective surfaces to fill with light.





GRANDE 36M



AZIMUT YACHTS



[The VIP staterooms offer a connected washroom and chaise lounges to enrich the space.]



RELAX AND UNWIND

Long stays on board are more comfortable below deck with large windows and plenty of personal storage.



[The raised pilot house has a commanding view over the clean and minimalist displays.
All auxiliary controls are hidden away within reach.]





GRANDE 36M



AZIMUT YACHTS





02

HER MAIN TECHNICAL FEATURES

The beauty of the Grande 36M is not solely a matter of exterior and interior design elements that combine to perfectly play out Azimut's essence. Her beauty lies also in discovering the technological advancements and special components that contribute to making her truly unique and highly innovative.



LOW EMISSION YACHT



D2P DISPLACEMENT TO PLANING HULL

The high-efficiency D2P® Displacement-to-Planing hull, combined with the extensive use of carbon fiber, reduces fuel consumption and CO₂ emissions by 20 to 30%* at both slow and fast cruising speeds. The double chine hull comes to a wave piercer at the bow, minimizing the impact of sea conditions while increasing the waterline length and therefore reducing drag.

*compared to vessels of the same weight and size with a traditional hard-chine hull.

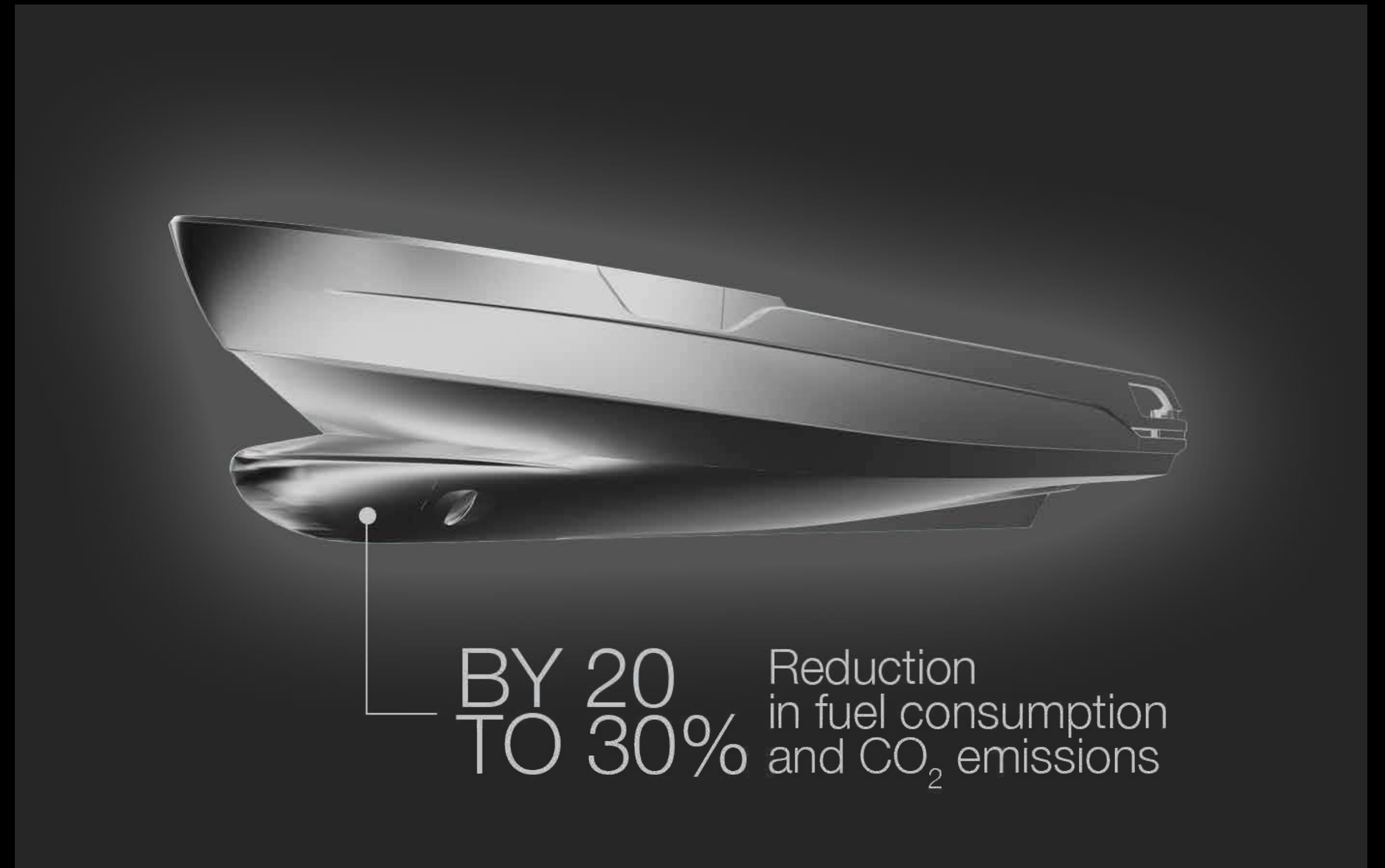

CARBON-TECH GENERATION

Azimut's pioneering use of carbon fiber lamination goes beyond pure performance. The Carbon-Tech Generation offers expanded volumes on board, while maintaining excellent dynamic stability and perfect handling. Preserving the yacht's low center of gravity, the carbon fiber was focused on the upper parts of the yacht, lightening the laminated components by up to 30% and reducing the natural roll momentum up to 15%.

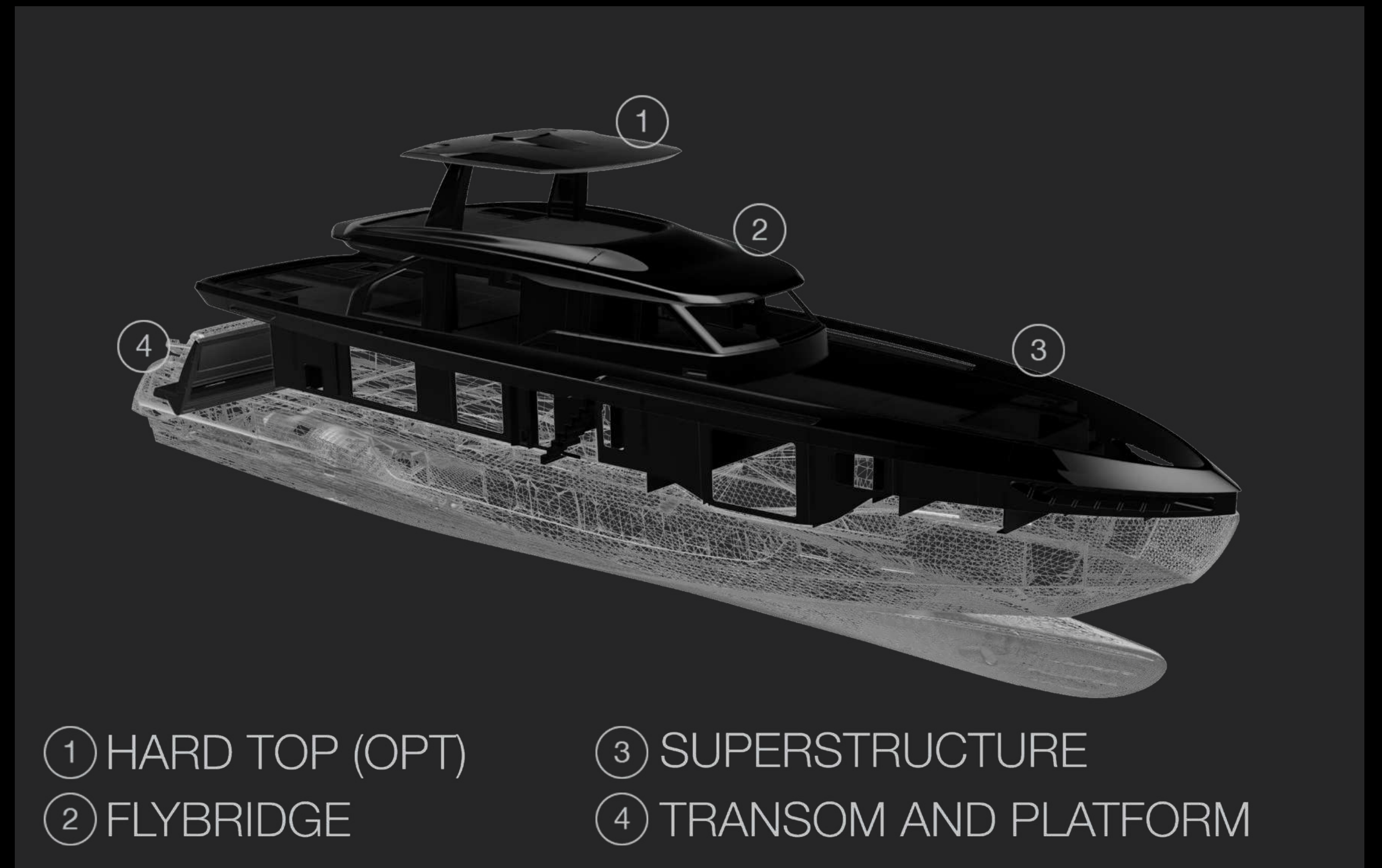

AIR TREATMENT AND VENTILATION SYSTEM

The yacht is equipped with an UTA air extraction system, which continuously exchanges and purifies the air on board. Through the use of extractors and air handling units, the rooms benefit from a continuous flow of fresh, clean air from the outside, filtering out most undesirable particulates and odors.

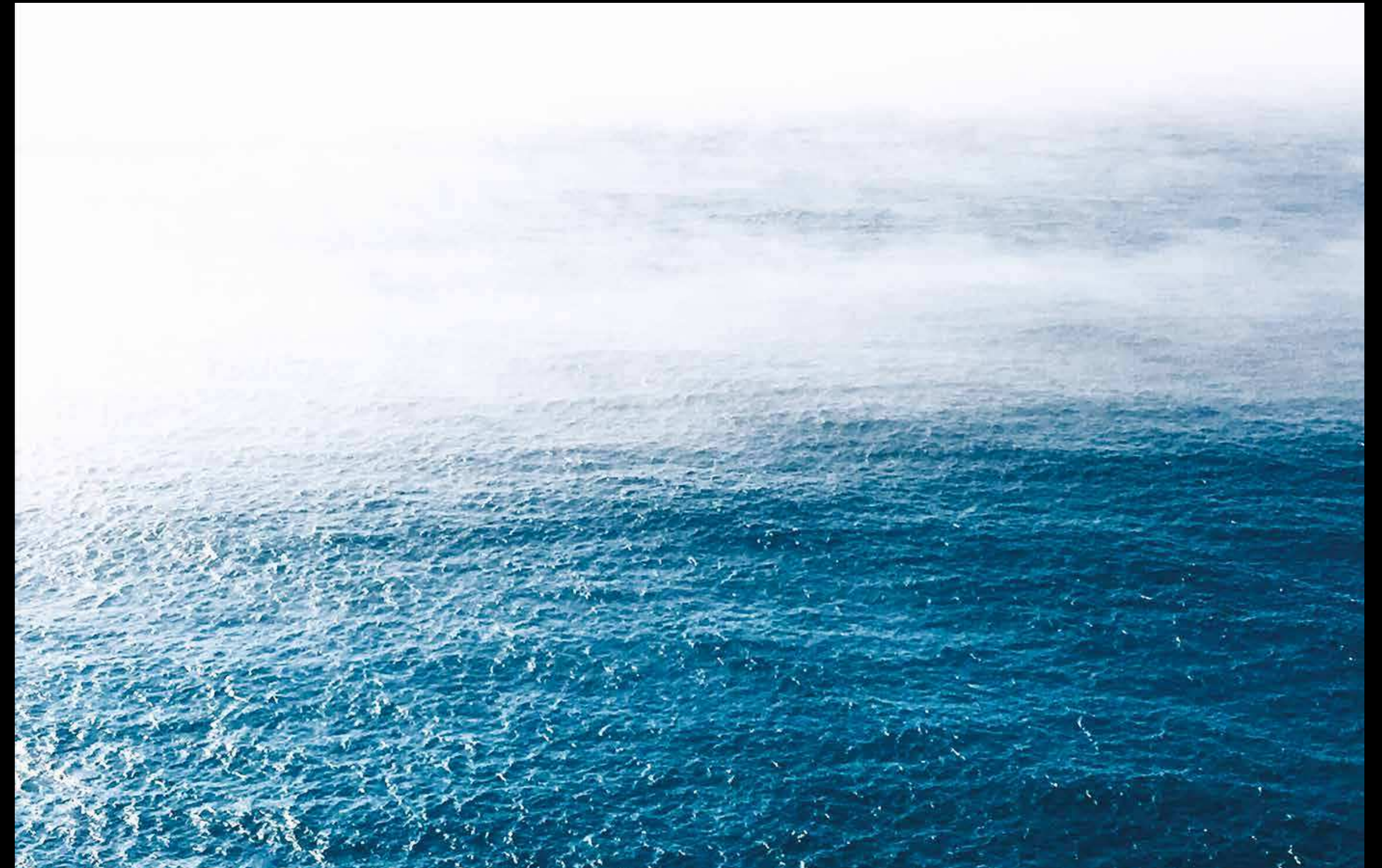

03

GRANDE 36M SPEC SHEET

GENERAL CHARACTERISTICS

LENGTH OVERALL	35,29 m	115’ 9”
BEAM MAX	7,5 m	24’ 7”
DRAFT	1,97 m	6’ 6”
DISPLACEMENT	approx. 180 t	396828 lb
ENGINES	2 x MTU 2200 hp	2 x MTU 2400 hp
MAXIMUM SPEED	up to 22/24 kn	
CRUISING SPEED	18/19 kn	
FUEL CAPACITY	19000 l	5020 US Gal
WATER CAPACITY	3700 l	977 US Gal
CABINS	5 + 4 crew	
BERTHS	10 + 6 crew	
HEAD COMPARTMENTS	6 + 4 crew	
BUILDING MATERIAL	Carbon fibre + GRP	
EXTERIOR DESIGNER	Alberto Mancini	
INTERIOR DESIGNER	Achille Salvagni Architetti	
HULL DESIGNER	P.L. AUSONIO Naval Architecture & Azimut Yachts R&D Dept.	
KEEL	D2P Displacement to planing hull	
BUILDER	Azimut Yachts	
CLASSIFICATION	Structural project compliant with Rina Class Pleasure Certificate (certificate upon request as optional)	

Last updated 04.2023
Please consult your dealer for the latest specifications.

UNI ISO 8666
The performance described applies to a vessel with standard configuration (standard equipment installed) and a clean hull, propellers, and rudder. It is also noted that the performance described was recorded under favourable sea and wind conditions (Beaufort scale index 1, Douglas scale index 1); different and worse sea conditions could significantly impact performance.

CE MARK
Given the continual evolution of technology, Azimut | Benetti S.p.A reserves the right to modify the technical specifications on its vessels at any time and without prior notice.

ABOVE VIEW

COUPÉ VERSION

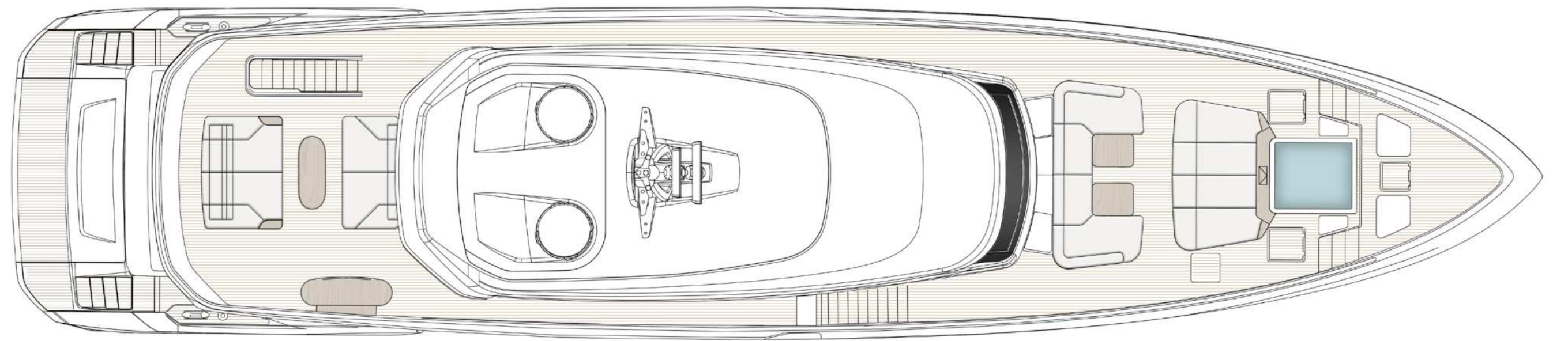

SUNDECK

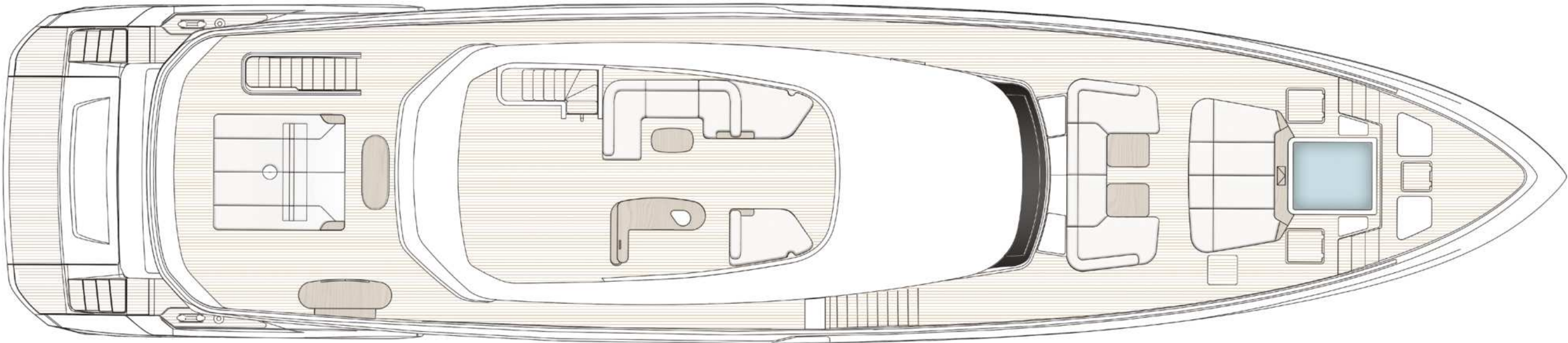

INFINITY SKYDECK

COUPÉ VERSION

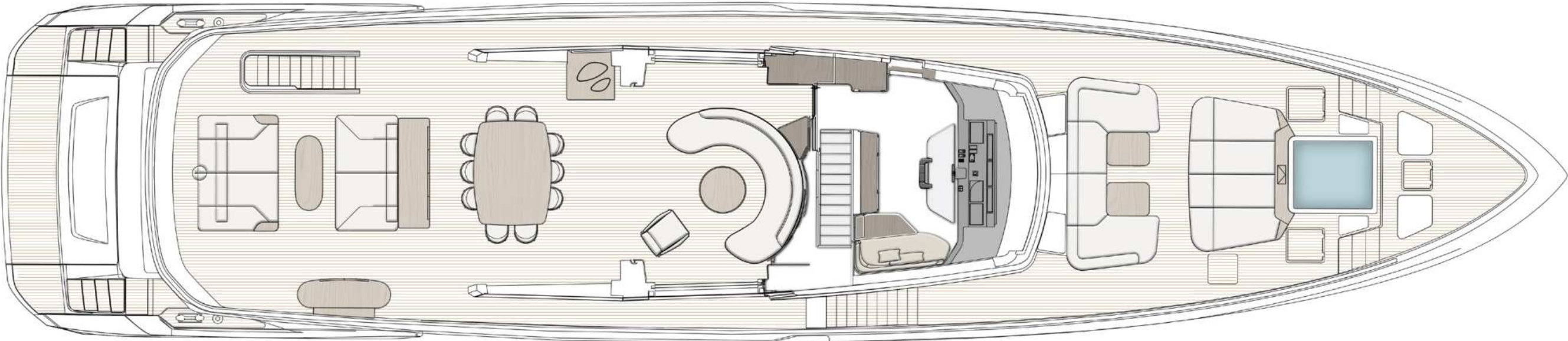

LOUNGE VERSION

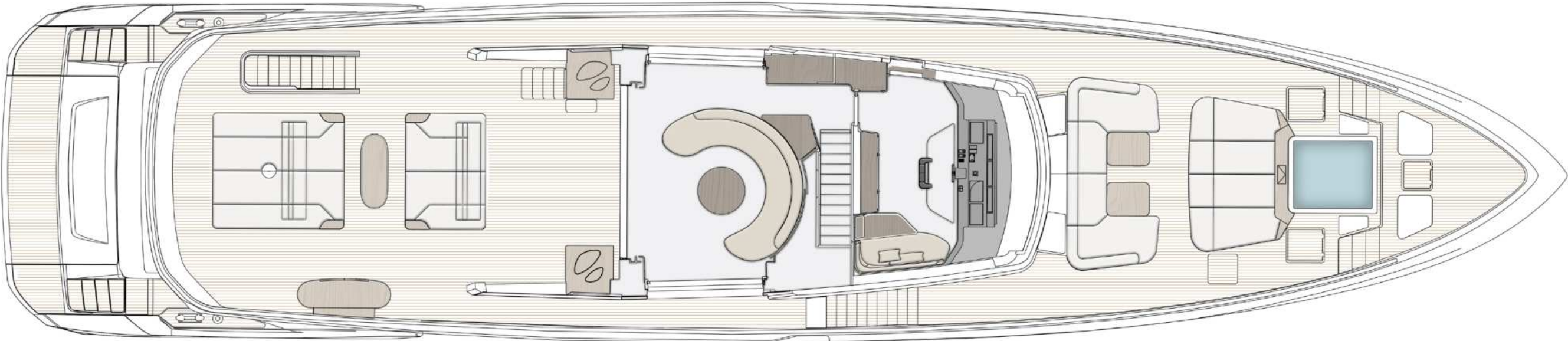

DINING VERSION

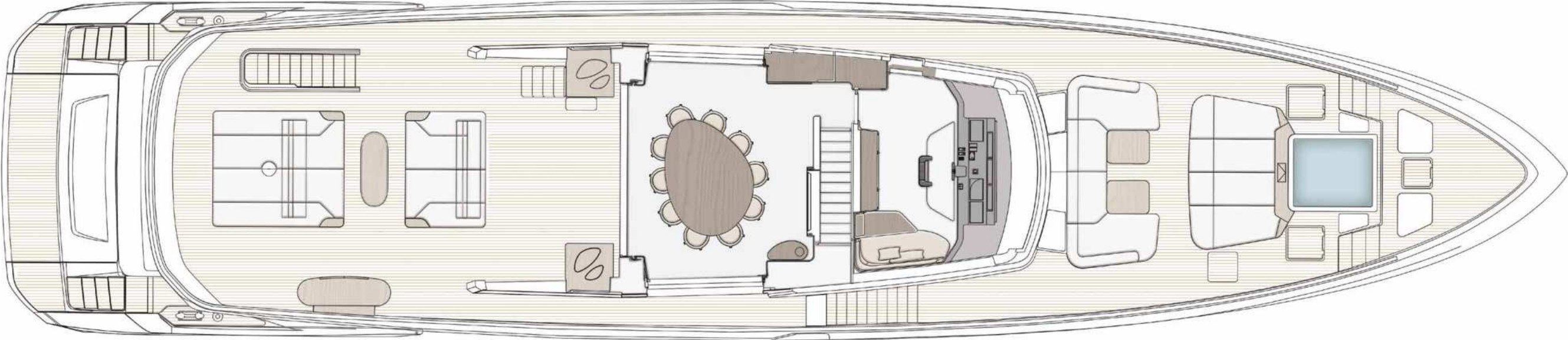

MAIN DECK

LOUNGE & DINING

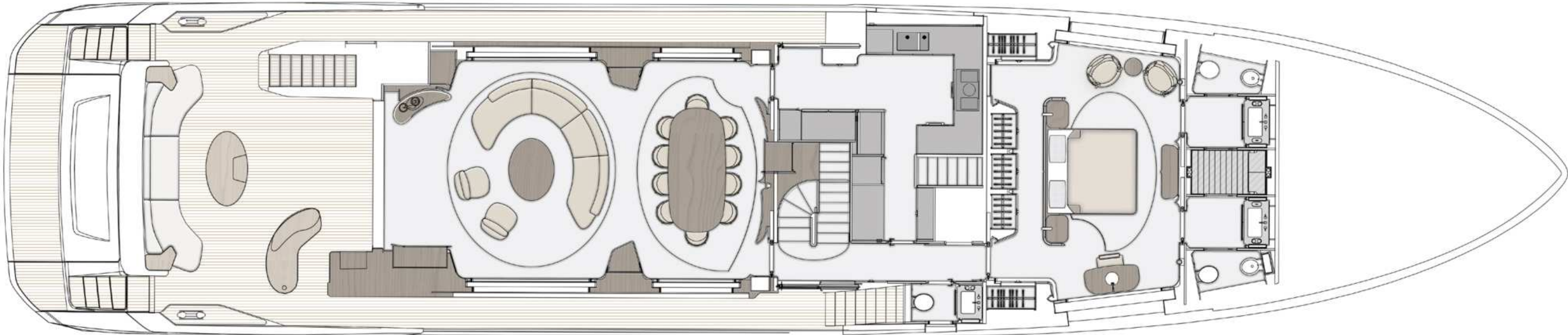

FULL LOUNGE

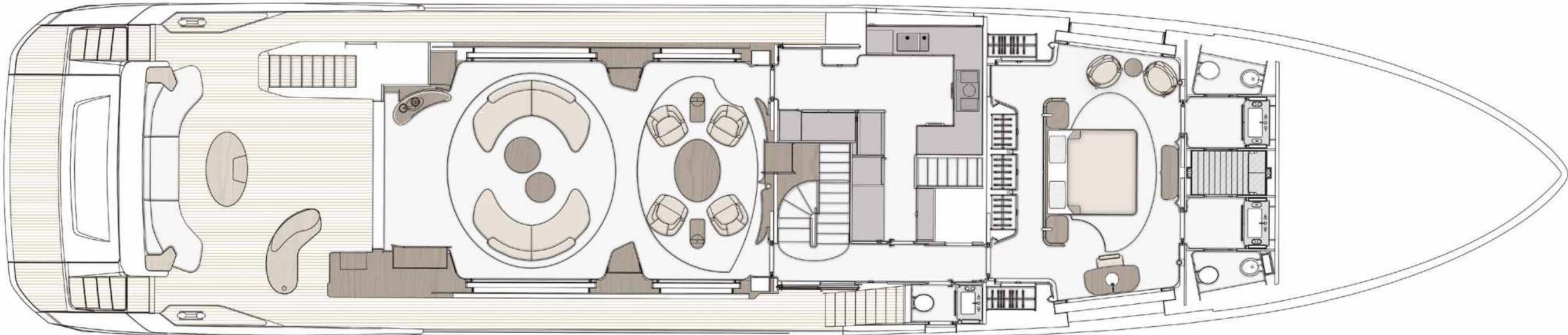

LOWER DECK

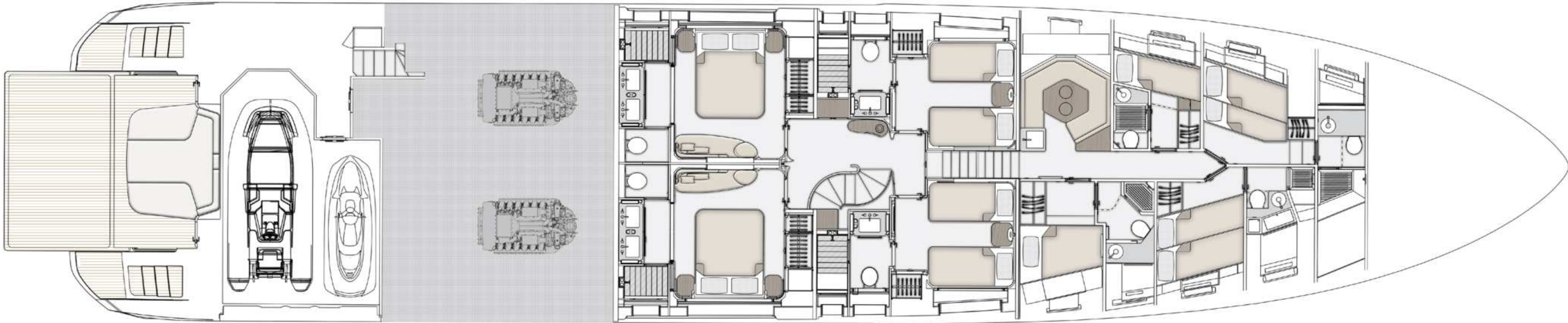



04

THE GRANDE SERIES

A FASCINATING VOYAGE THROUGH INNOVATION

Inspired by an affinity for grandeur, the Azimut Grande Series is a unique and emotional ensemble of Azimut's most pioneering inspiration and constructive flair, a spectacular collection of works of art that combines advanced technology with engineering mastery. Visionary design, punctuated by surprising innovation, reimagines the function of space and revolutionizes lifestyle onboard, while exclusively curated ambiances express the creative touch and aesthetic of authentic Made in Italy.

Savor the magnificence of futuristic ingenuity.

26M

27M

32M

36M

TRIDECK



05

ABOUT AZIMUT



A FAMILY-MADE COMPANY CULTURE

An immense and personal passion for the sea. A clear and forward-facing attitude. A strong and relentless work ethic. Since 1969, Paolo Vitelli, the creative visionary founder and businessman behind Azimut, has been set on challenging the industry's status quo with a daring desire: bring to life an unexpected nautical experience, through yachts built to combine alluring aesthetics with construction expertise and impeccable technology.

An audacious mindset that has, over time, surprised and captivated the yachting sector, transforming Azimut into a bold and recognizable benchmark, and laying the foundation for the birth of the largest megayacht builder in the world, the Azimut | Benetti Group.

The international and management-based standing of the company today, is deeply nourished by the solid and memorable family heritage that has distinguished it from the beginning. A historically pioneering vision that enables it to continue thriving day after day, through ingenious inventions and long-term goals that look to the future with Paolo's daughter, Giovanna Vitelli.

A SUSTAINABLE VISION TODAY, FOR TOMORROW

An avant-garde vision and a strong emotional appeal have shaped the history of Azimut as a leader in the field of nautical innovation as well as its commitment to the creation of a sustainable-oriented and attentive company culture today.

An ambitious and personal touch that has allowed Azimut to grow and evolve on both levels, embracing the challenge of a future nurtured by an eco-conscious approach to boat construction and by an authentic focus and responsibility on human well-being.





OUR ECO-YACHTING PHILOSOPHY

The Azimut I Benetti Group has made tangible investments to guide the Technical as well as the R&D departments toward the construction of yachts with a diminished environmental impact. Its main areas of intervention have focused on significantly lowering fuel consumption and CO2 emissions through the development of highly efficient hull designs, innovative propulsion systems and an extensive use of carbon fiber to decrease yacht weight.



A SAFE AND HEALTHY WORK ENVIRONMENT

The forerunning shipyard of Avigliana was the first of the company's Italian shipyards to obtain the ISO 45001 certification in 2011, attesting its rigorous abidance to all occupational health and safety requirements. Recognized as the most technologically-advanced shipyard in Europe, it has also led the nautical sector revolution in terms of being among the earliest adopters of the vacuum infusion process to drive resin into a laminate, avoiding styrene emissions and therefore guaranteeing its precious workers a healthier setting.

As of 2013, all the other Italian production sites have adapted to meet the necessary requirements to obtain the ISO 45001 certification.



GRANDE 36M



AZIMUT YACHTS

A GLOBALLY-CONNECTED DEALER AND SERVICE NETWORK

5 SHIPYARDS

6 DIRECT OFFICES

138 OFFICIAL DEALERS

80 COUNTRIES

The highly widespread commercial network put in place by Azimut Yachts, allows the company to offer a continuous presence to its ship owners, concretely curating their demands by meeting their most specific needs.

Find your Dealer →



THE LARGEST PRIVATE GROUP IN THE YACHTING WORLD

Azimut is part of the Azimut | Benetti Group, the biggest private player and shipbuilder in the nautical sector today. The Vitelli family, the founder and majority shareholder of the company, has been leading the way for over fifty years now, continuing to innovate through the Group's main yacht brands, Azimut and Benetti, while developing a variety of service brands to cater to the different demands of ship owners worldwide.



OUR SHIPYARDS MAKE US PROUD

Avigliana — Italy

HQ / SHIPYARD

Savona — Italy

DELIVERY CENTRE

Viareggio — Italy

SHIPYARD / STYLING LOUNGE

Fano — Italy

SHIPYARD

Itajaí — Brazil

SHIPYARD

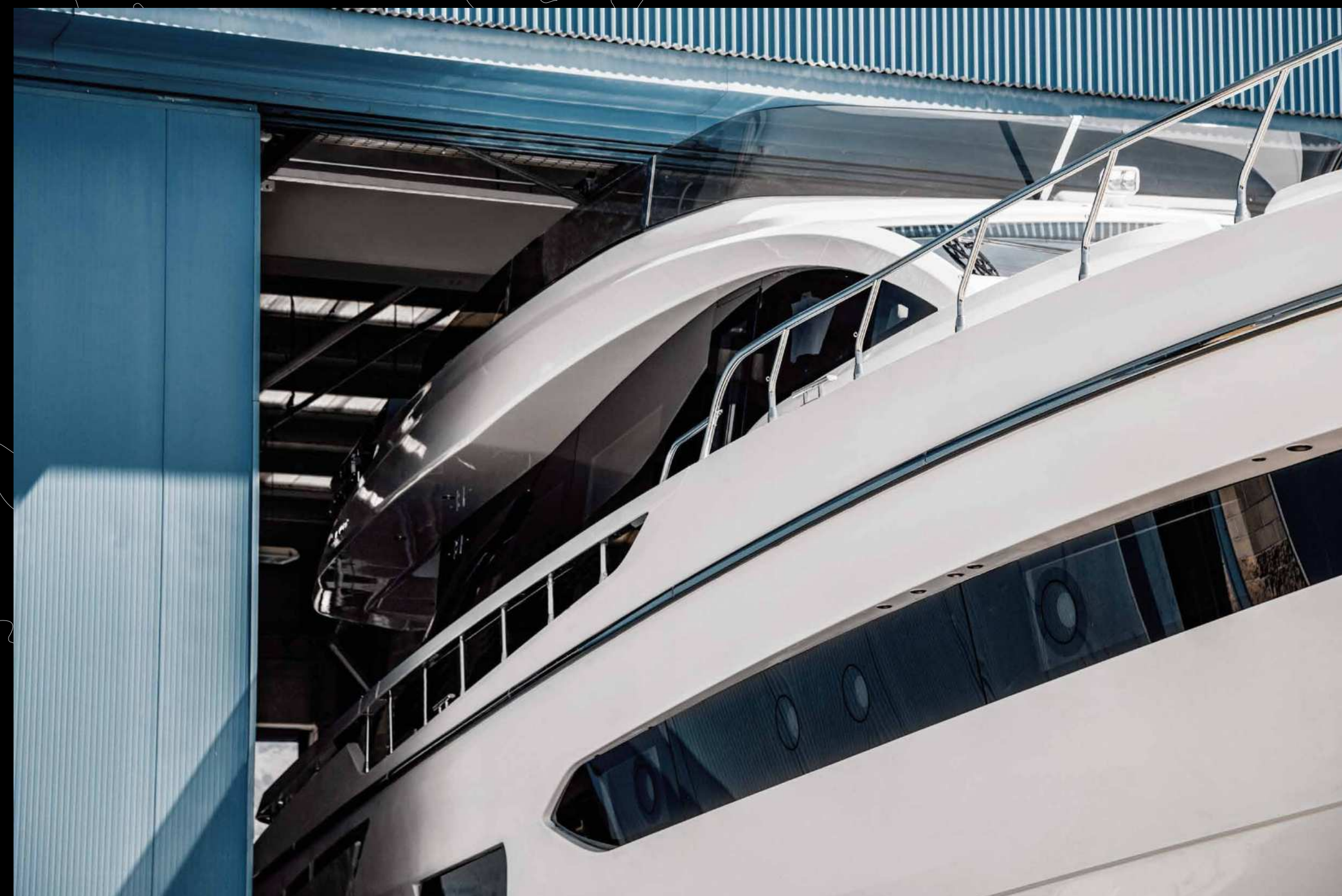



PHOTOS: ALESSANDRO GUERRIERI, MICHELA LOCCI

AZIMUT YACHTS THANKS:
ALDUS, ACHILLE SALVAGNI ARCHITETTI, OLIVERI

OFFICIAL PARTNERS



AZIMUT | BENETTI SPA
VIA MARTIN LUTHER KING, 9
10051 AVIGLIANA, TORINO
ITALY

RELEASE 01.24

This brochure in no way constitutes a contract of sale for the boatyard's vessels to any person or company. All information contained herein, including but not limited to technical and performance data, illustrations, and drawings, is non-binding and for purposes of illustration only. The information in this brochure refers to the boatyard's standard motoryacht models available as of the date of publication. Technical and descriptive information is valid only to the extent that it pertains to the specific vessel that is the subject of a purchase. Contract terms are valid only to the extent that they are contained in a contract of sale. This document is based on information available at the time of publication. Despite efforts to ensure the greatest possible accuracy, the information contained herein may fail to cover all details, omit technical or commercial changes that may have been made subsequent to publication, describe features that are not present, and fail to envisage all circumstances that might occur. Any illustrations, photographs, diagrams and examples shown in this brochure are included solely for the purposes of illustrating the text. Due to the different features of each vessel, the boatyard assumes no liability for actual use based on the illustrated applications.

^ZIMUT

azimutyachts.com

