

INDEX

01	THE DESIGN & LIFESTYLE ON BOARD	P04
02	HER MAIN TECHNICAL FEATURES	P33
03	GRANDE 27M SPEC SHEET	P41
04	THE GRANDE SERIES	P46
05	ABOUT AZIMUT	P56



A one-of-a-kind beauty, enrapturing,
that steals your breath away, leaving you
speechless. An extraordinary idea as the only
possible pathway, to get to where you want,
to explore, to go beyond.

The freedom of embracing the unknown,
that you know you'll love as a part of
your very own story. A thought that provokes
your mind and then inspires you to aim for the
impossible, making mistakes, yet being brave.
A magic je ne sais quoi that enchants and
intrigues you, moving you to feel more and
to sense uniqueness.

The choice to risk it all, the one that makes you
go for it, to impress yourself and all those who
are worth it.

AZIMUT.
DARE TO AMAZE.



01

THE DESIGN & LIFESTYLE ON BOARD

GRANDE 27M, AN UNEXPECTED IDEA OF SPACE

A compact superyacht with an imperial essence, the Azimut Grande 27M exhibits a multi-talented philosophy by combining sumptuous comfort with performance.

As the first of her kind to offer a raised pilot house, this pioneering boat piece reimagines environments by capitalizing on space, introducing the owner's suite on the main deck as well as four guest cabins below it. The extensive use of carbon fiber effectively ensures generous volumes without impacting the weight, enabling this vessel to deliver a highly comfortable maritime lifestyle.

Let the Grande 27M impress you.



[Designed by the skilled hand of Stefano Righini, this unique concept wide body superyacht enshrines perfect harmony between flowing lines and modern dynamism]



[A symphony for sight from the profile, the Grande 27M is wrapped in exterior design that visually breaks down her substantial volumes to make a sleek and sportive impression.]

Welcome aboard, ladies and gentlemen.

Let us begin the tour.



UNIQUE, JUST LIKE YOUR VIEW OF THE SEA.



[A natural tension permeates the yacht's silhouette, hiding the generous interior volumes.]

The masterful play of lines and curves gives rise to a natural tension, which runs from the bow to the extreme stern, dressing the abundant interior volumes with a gritty and dynamic exterior design. The long full-height windows extend from the hull to the superstructure, further lightening the yacht's appearance while expanding the sense of space inside.



NO BORDERS, JUST HORIZONS

The wide-open lounge area on the bow acts as an expansive sea terrace, inviting guests to sprawl and socialize in the sun.







A spectrum of shelter and furniture ensure that every form of lounging is comfortably accommodated on the yacht's largest flush outdoor deck.

BREATHTAKING OPEN-AIR BEAUTY



WELLBEING AT THE WATER'S EDGE

The innovative Pivoting Platform Expander folds the transom down in beach mode, making more space right on the water. This unique solution can keep rotating to make launching the tender a breeze.



CALM AND SOPHISTICATION

The experiential philosophy of the architecture is incompatible with barriers and hard limits. A succession of contrasting frames embrace each area, softly subdividing the space with a curve at the corners like the clean full-height window frames.







[Flowing lines and fine materials are carefully combined to create a cozy and sophisticated sense of luxury.]

A SEA-IMMERSIVE EXPERIENCE



The coziest common area on board is joined with the outdoors through the expansive aperture onto the cockpit, with the peripheral windows completing the nearly 270-degree immersion in nature.



[The large side windows allow light to reflect off the water and filter in to the interiors, enhancing the thrill of looking out to sea.]

Now, let us discover the guest accommodations.

Shall we?





AN ENHANCED SENSE OF SUITE-NESS

The Grande 27M makes use of her generous volumes to offer all the space needed for long, serene journeys. The full beam owner's cabin has expansive windows that flood the spaces with light, while a full-beam bathroom and a dressing room complete the suite.





Each of the staterooms is characterized by a matte, textured wood, juxtaposed against a darker, polished kind. The contrast is enriched by a series of inserts in exclusive materials like treated brass, bronze and polished stainless steel.

A BRIGHT AND FLOWING AMBIENCE

The full-height windows on both sides flood the owner's suite with light as if the walls were made of glass, expanding the perceived space and synergizing with the sophisticated selection of materials.





GRANDE 27M



AZIMUT YACHTS

FLUID AMBIENCES







GRANDE 27M

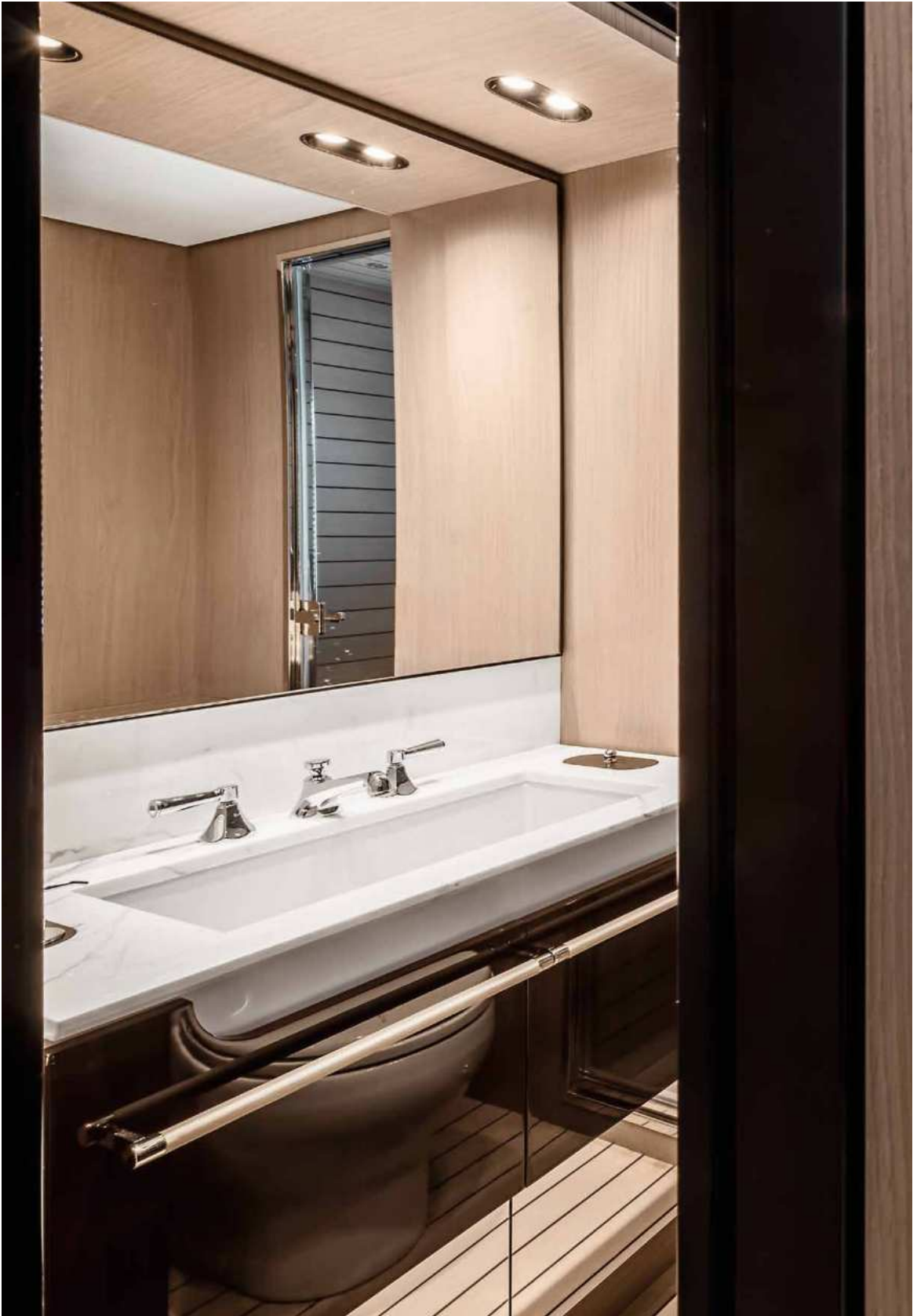

AZIMUT YACHTS

THE ART OF HOSPITALITY







02

HER MAIN TECHNICAL FEATURES

The beauty of the Grande 27M is not solely a matter of exterior and interior design elements that combine to perfectly play out Azimut's essence. Her beauty lies also in discovering the technological advancements and special components that contribute to making her truly unique and highly innovative.



LOW EMISSION YACHT



D2P DISPLACEMENT TO PLANING HULL

The high-efficiency D2P® Displacement-to-Planing hull, combined with the extensive use of carbon fiber, reduces fuel consumption and CO₂ emissions by 20 to 30%* at both slow and fast cruising speeds. The double chine hull comes to a wave piercer at the bow, minimizing the impact of sea conditions while increasing the waterline length and therefore reducing drag.

*compared to vessels of the same weight and size with a traditional hard-chine hull.

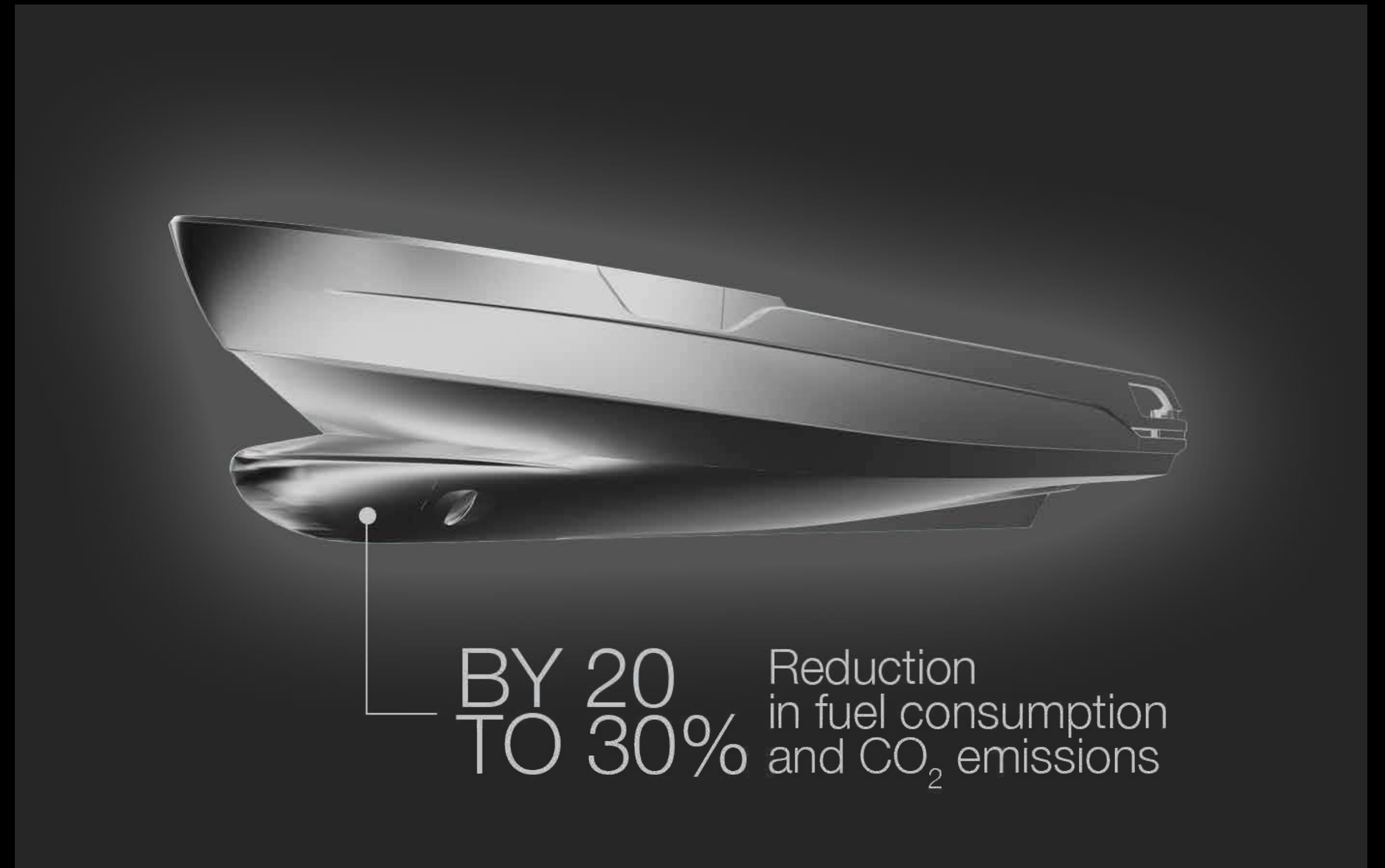

CARBON-TECH GENERATION

Azimut's pioneering use of carbon fiber lamination goes beyond pure performance. The Carbon Tech Generation offers expanded volumes on board, while maintaining excellent dynamic stability and perfect handling. Preserving the yacht's low center of gravity, the carbon fiber was focused on the upper parts of the yacht, lightening the laminated components by up to 30% and reducing the natural roll momentum up to 15%.

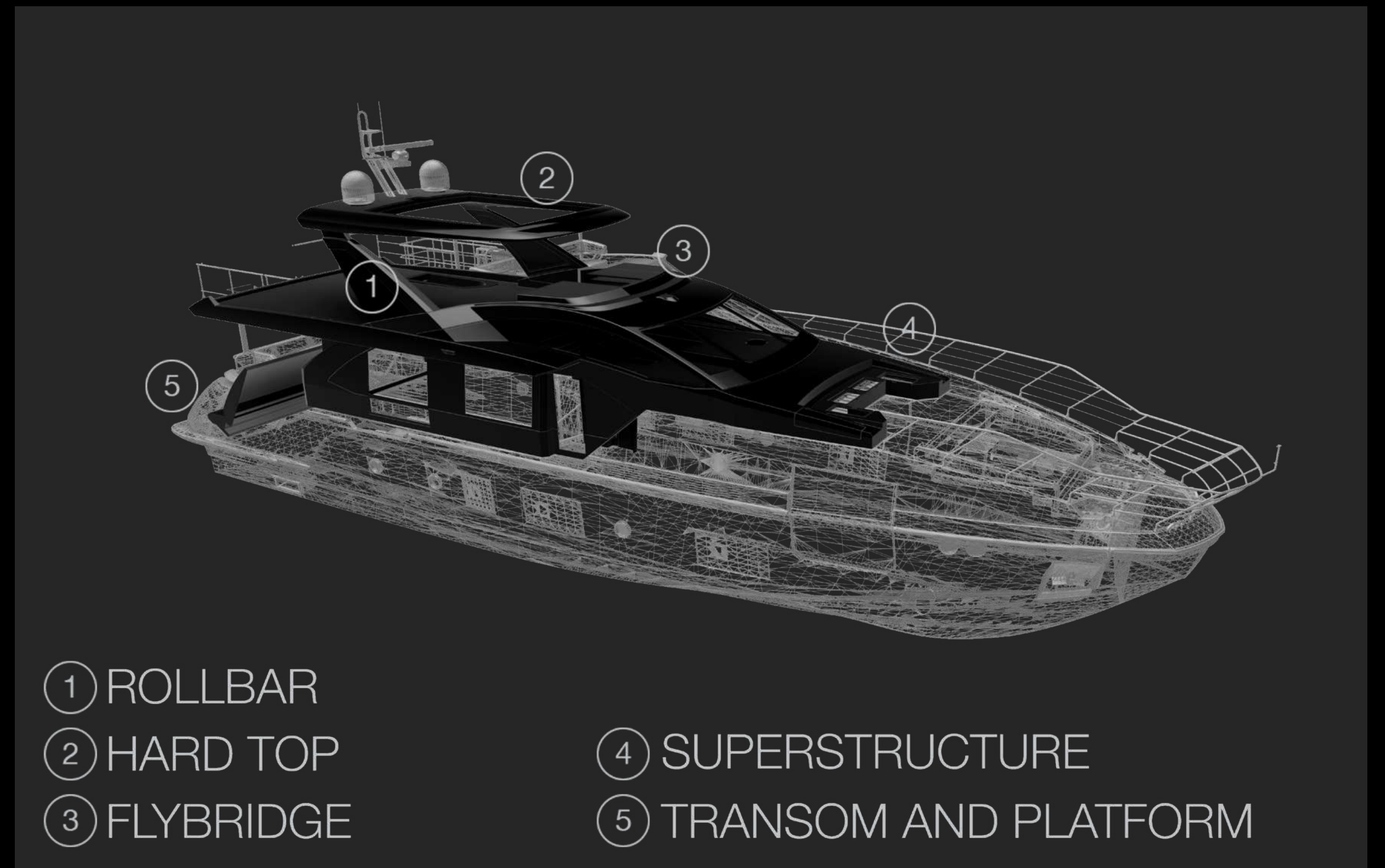

ACTIVE TRIM CONTROL

Automatic interceptors by Humphree gives the vessel the lift it needs to get up on plane faster or to reach that optimum running trim. In this way the resistance of the hull is automatically optimised for every speed and load condition, this resulting in increased speed and lower fuel consumption. The Humphree system is all electric powered by 12-24 Volt DC. Thanks to the design of the Interceptor it only requires a small amount of power to move the blade up and down, even under high speed operation.



ADVANCED STABILIZATION SYSTEM

The stabilization system consists of Stabilis Electra™ stabilizing fins and Dualis Electra™ thrusters. Reliable, precise and silent, the stabilizing fins are even capable of reducing energy consumption. The thrusters' quality casting and mechanics yield a high thrust-to-power ratio, higher than other systems.

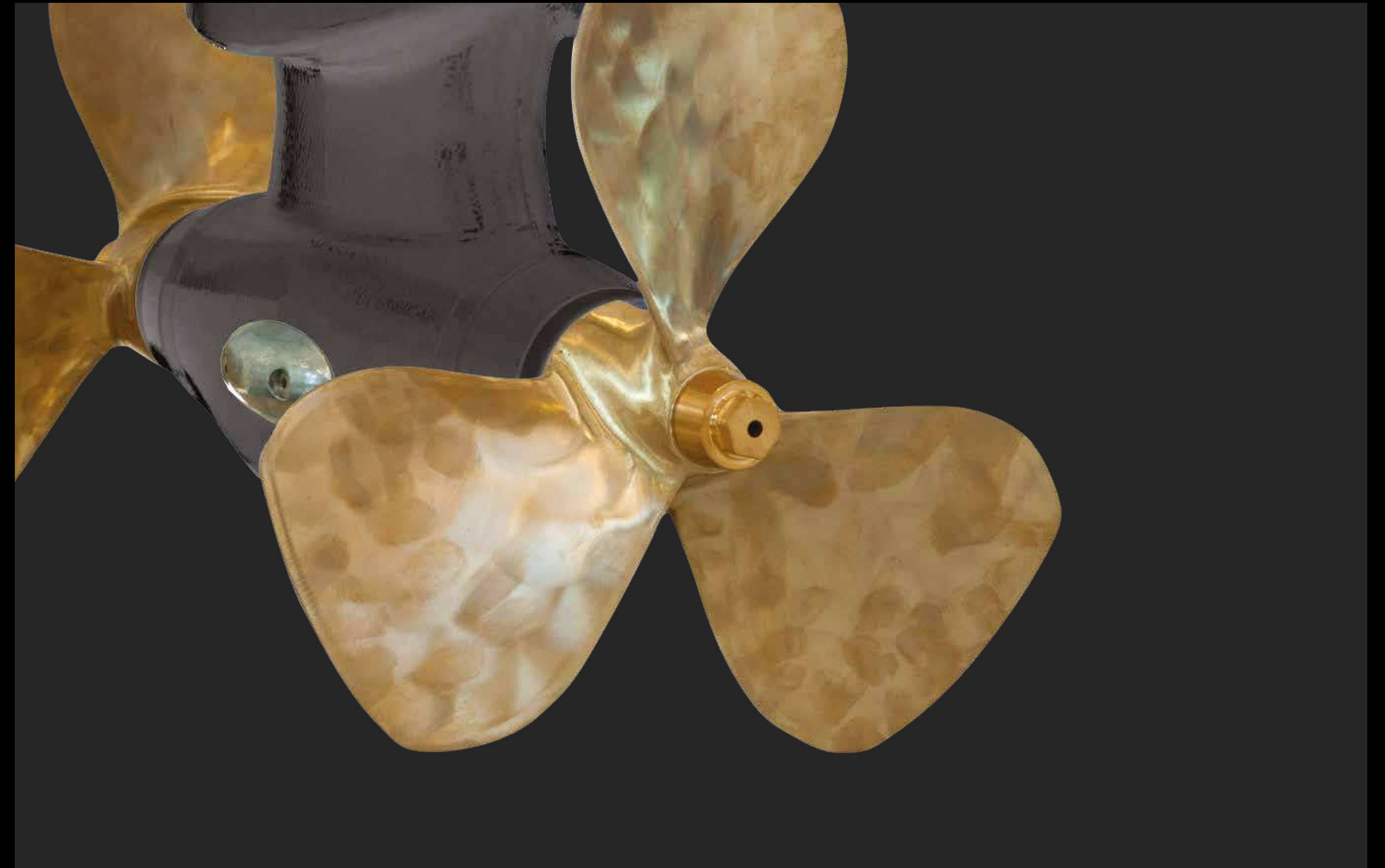

HI-TECH CONTROL & MONITORING

The helm displays consolidate all the functions of the yacht with Simrad Command, from the visualization of engine data and related consumption, to the control of generators, trim and interceptor management, lights, batteries and air conditioning. There are also advanced navigation tools and system automations to make the pilot's job easier.



HTS HIGH TECHNICAL STANDARD DECLARATION

This yacht’s design and engineering meet the highest standards for production recreational vessels. Azimut Yachts issues a declaration of the premium materials, advanced technology and rigorous testing procedures.



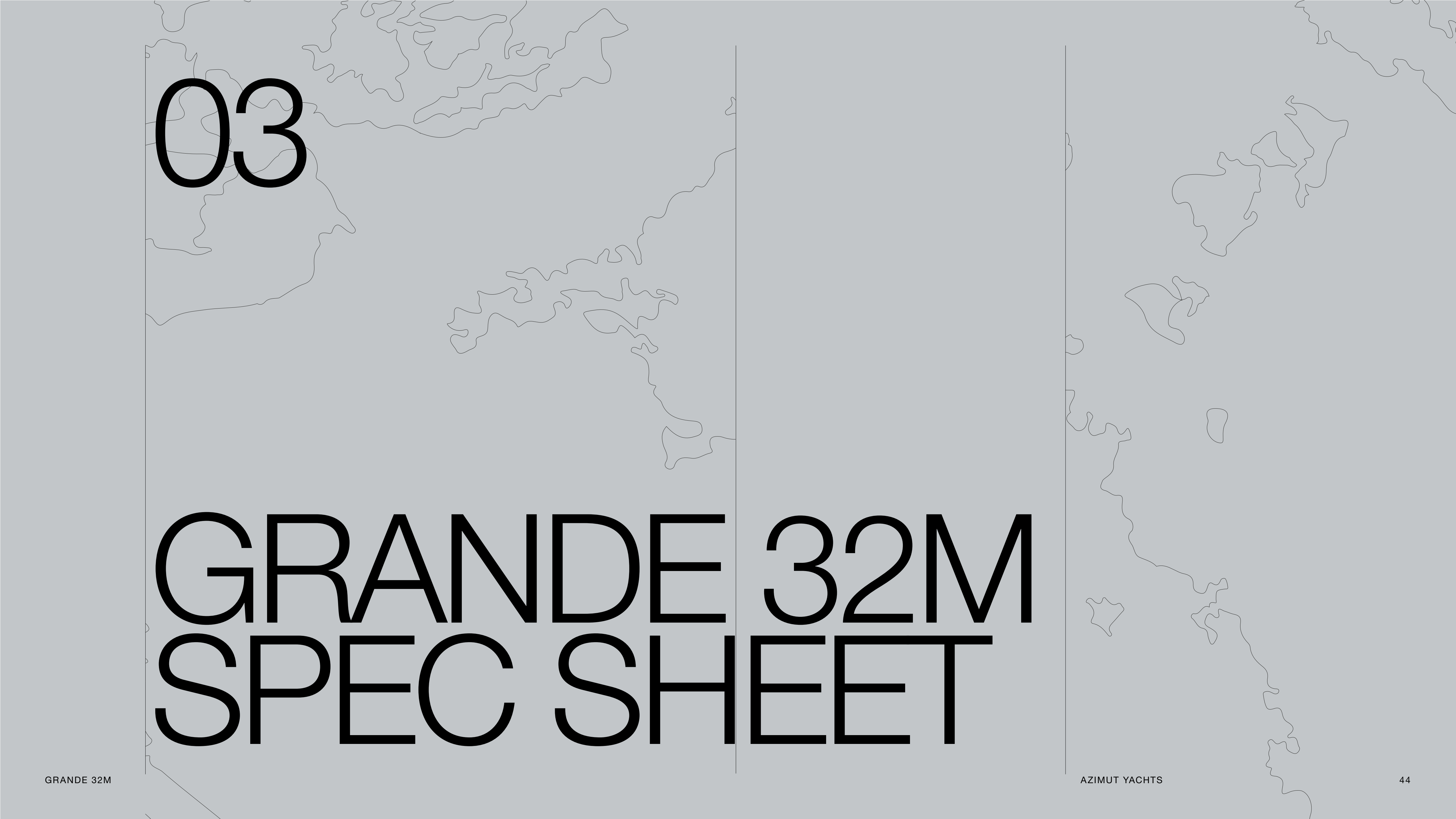

03

GRANDE 27M SPEC SHEET

GENERAL CHARACTERISTICS

LENGTH OVERALL	26,78 m	87’ 10”
BEAM MAX	6,59 m	21’ 7”
DRAFT	1,93 m	6’ 4”
DISPLACEMENT	93 t	205.030 lb
ENGINES	2 x MAN R V12 1900 hp	
MAXIMUM SPEED	up to 28 kn	
CRUISING SPEED	up to 24 kn	
KEEL	Planante	
FUEL CAPACITY	9500 l	2510 US Gal
WATER CAPACITY	2000 l	528 US Gal
CABINS	4 + 2 crew	
BERTHS	8 + 3 crew	
HEAD COMPARTMENTS	5 + 2 crew	
BUILDING MATERIAL	Carbon Fibre + GRP	
EXTERIOR DESIGNER	Stefano Righini	
INTERIOR DESIGNER	Achille Salvagni Architetti	
HULL DESIGNER	P.L. AUSONIO Naval Architecture & Azimut R&D Dept.	
BUILDER	Azimut Yachts	
CERTIFICATIONS	CE A; NMMA	

Last updated 10.2022
Please consult your dealer for the latest specifications.

UNI ISO 8666
The performance described applies to a vessel with standard configuration (standard equipment installed) and a clean hull, propellers, and rudder. It is also noted that the performance described was recorded under favourable sea and wind conditions (Beaufort scale index 1, Douglas scale index 1); different and worse sea conditions could significantly impact performance.

CE MARK
Given the continual evolution of technology, Azimut | Benetti S.p.A reserves the right to modify the technical specifications on its vessels at any time and without prior notice.

FLYBRIDGE

WHEELHOUSE

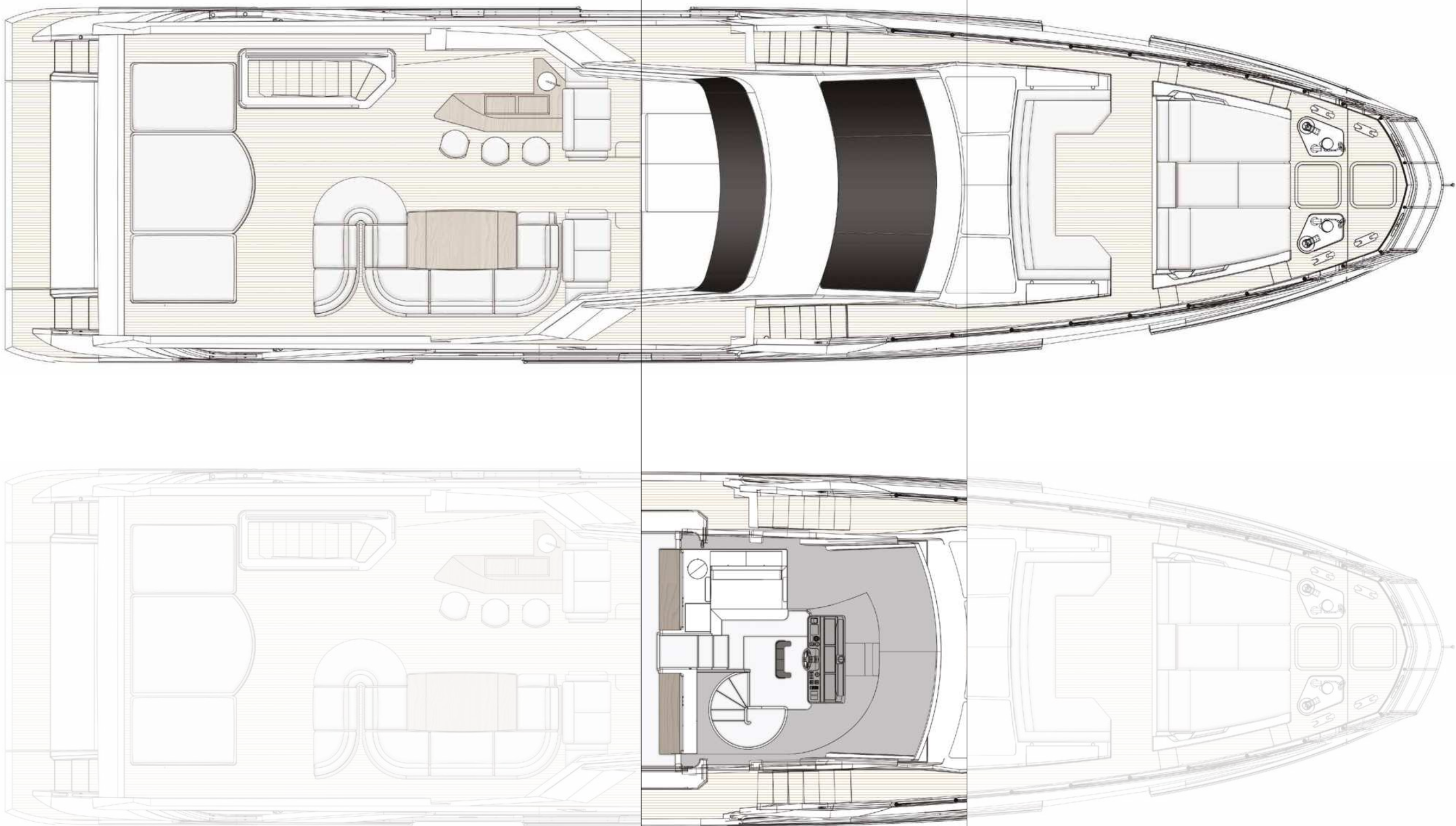

MAIN DECK

OWNER'S SUITE
ON MAINDECK

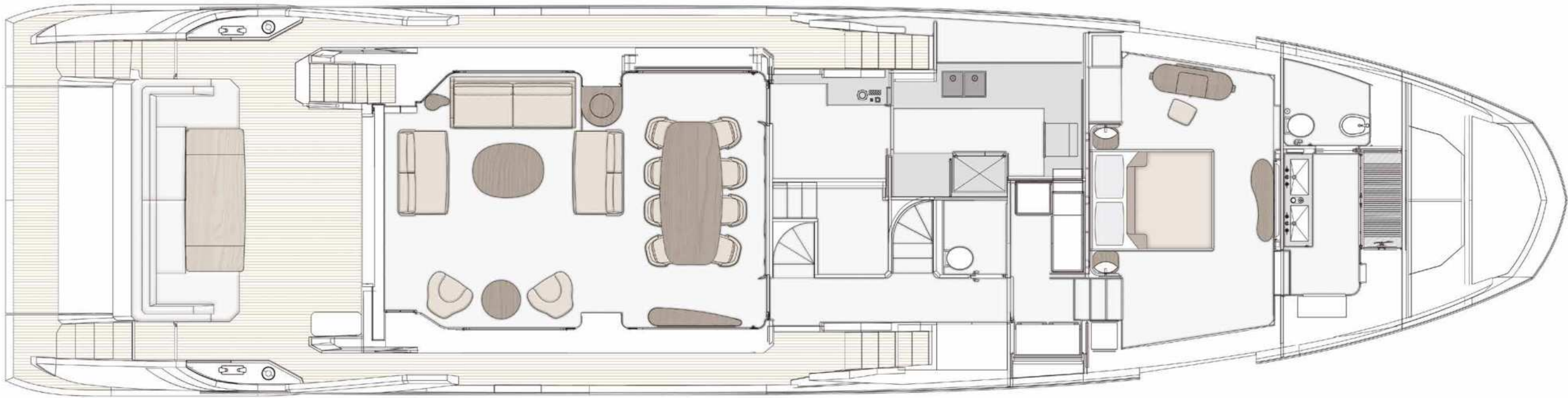

LOWER DECK

4 CABIN VERSION
WITH OWNER'S SUITE ON MAINDECK

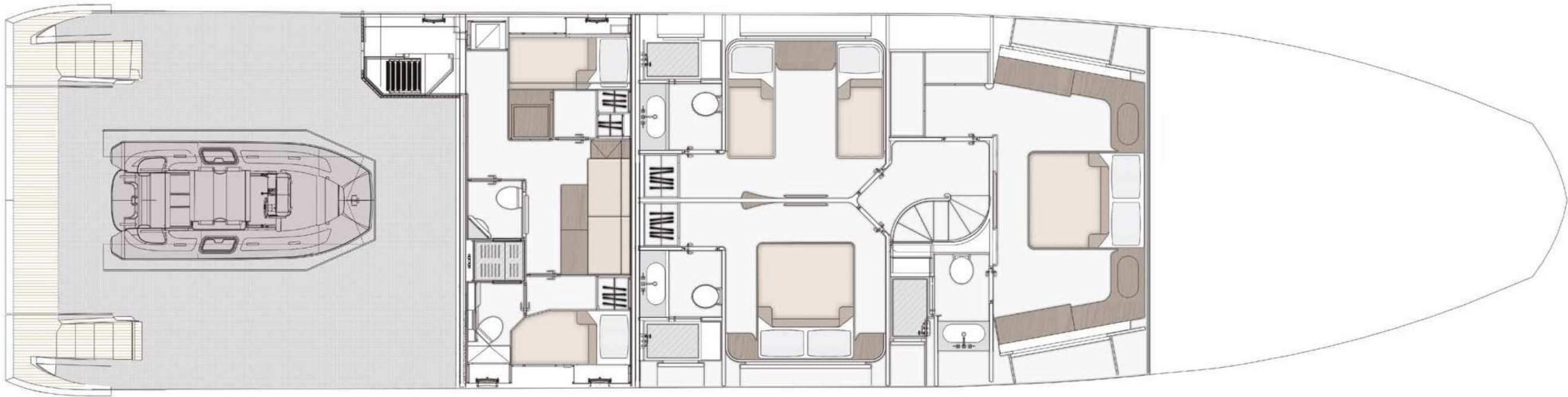

5 CABIN VERSION
WITH OWNER'S SUITE ON MAINDECK

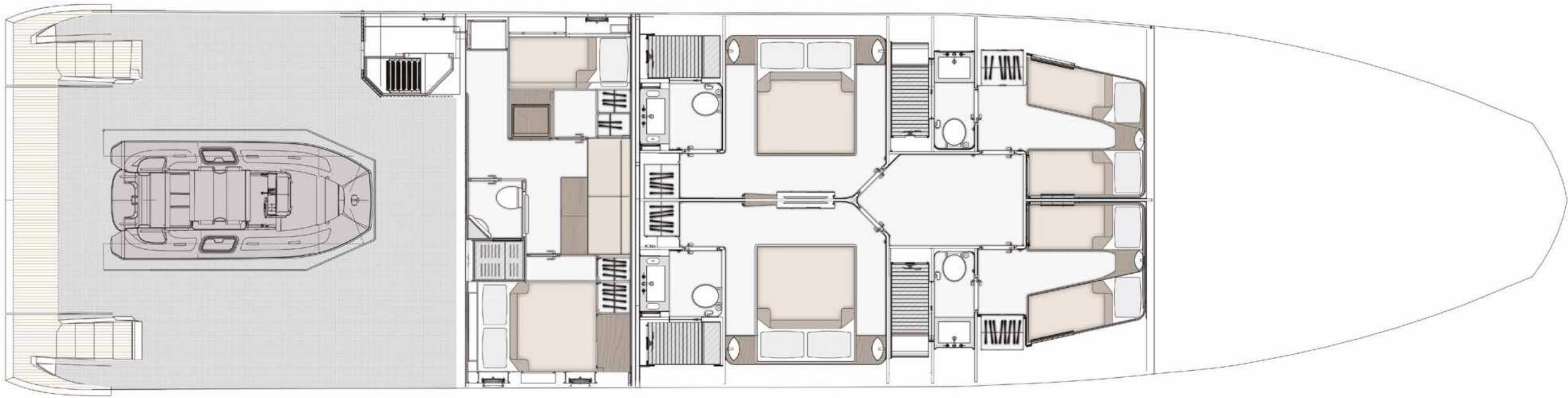



04

THE GRANDE SERIES

A FASCINATING VOYAGE THROUGH INNOVATION

Inspired by an affinity for grandeur, the Azimut Grande Series is a unique and emotional ensemble of Azimut's most pioneering inspiration and constructive flair, a spectacular collection of works of art that combines advanced technology with engineering mastery. Visionary design, punctuated by surprising innovation, reimagines the function of space and revolutionizes lifestyle onboard, while exclusively curated ambiances express the creative touch and aesthetic of authentic Made in Italy.

Savor the magnificence of futuristic ingenuity.

26M

27M

32M

36M

TRIDECK



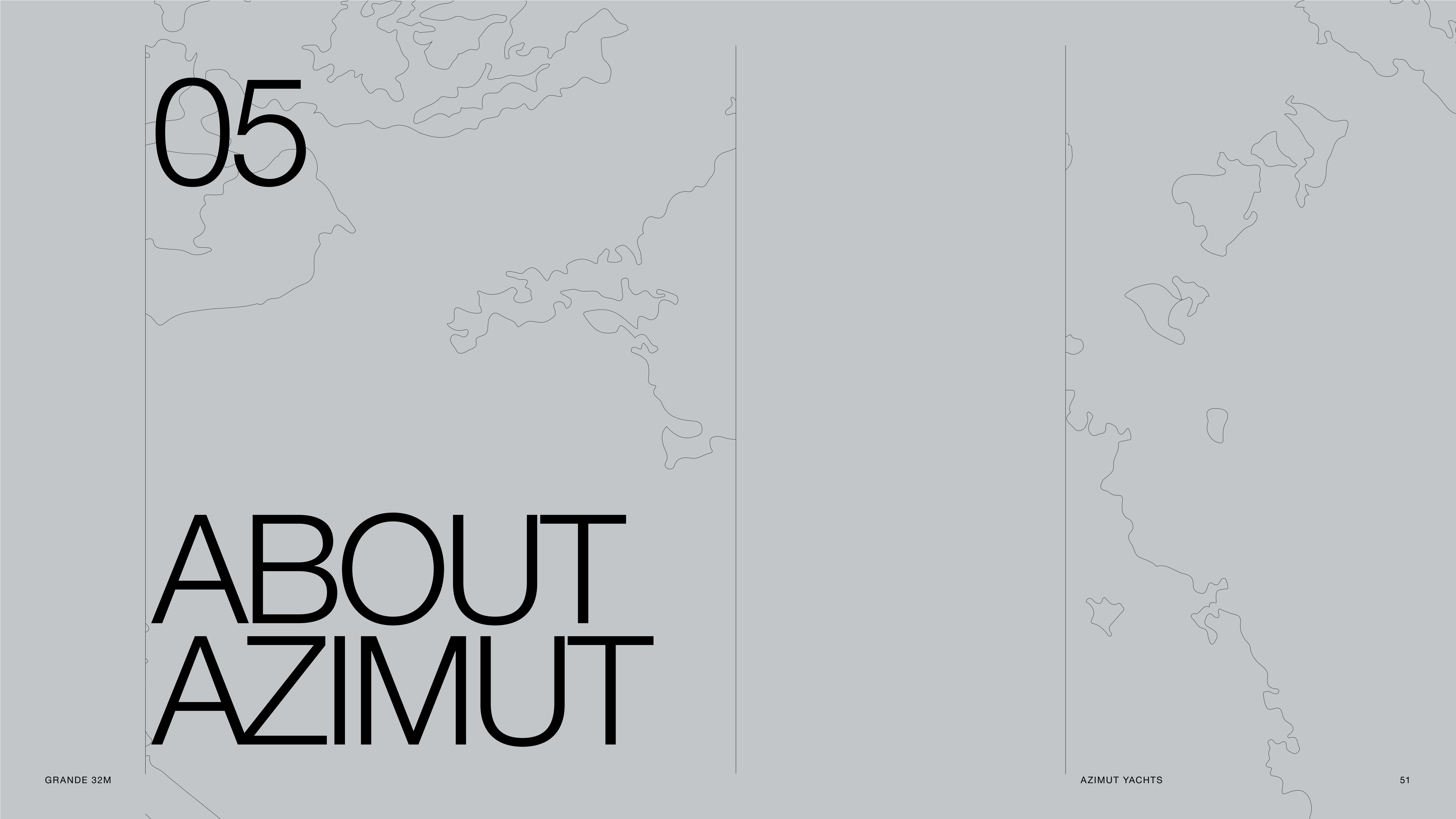

05

ABOUT AZIMUT



A FAMILY-MADE COMPANY CULTURE

An immense and personal passion for the sea. A clear and forward-facing attitude. A strong and relentless work ethic. Since 1969, Paolo Vitelli, the creative visionary founder and businessman behind Azimut, has been set on challenging the industry's status quo with a daring desire: bring to life an unexpected nautical experience, through yachts built to combine alluring aesthetics with construction expertise and impeccable technology.

An audacious mindset that has, over time, surprised and captivated the yachting sector, transforming Azimut into a bold and recognizable benchmark, and laying the foundation for the birth of the largest megayacht builder in the world, the Azimut | Benetti Group.

The international and management-based standing of the company today, is deeply nourished by the solid and memorable family heritage that has distinguished it from the beginning. A historically pioneering vision that enables it to continue thriving day after day, through ingenious inventions and long-term goals that look to the future with Paolo's daughter, Giovanna Vitelli.

A SUSTAINABLE VISION TODAY, FOR TOMORROW

An avant-garde vision and a strong emotional appeal have shaped the history of Azimut as a leader in the field of nautical innovation as well as its commitment to the creation of a sustainable-oriented and attentive company culture today.

An ambitious and personal touch that has allowed Azimut to grow and evolve on both levels, embracing the challenge of a future nurtured by an eco-conscious approach to boat construction and by an authentic focus and responsibility on human well-being.





OUR ECO-YACHTING PHILOSOPHY

The Azimut I Benetti Group has made tangible investments to guide the Technical as well as the R&D departments toward the construction of yachts with a diminished environmental impact. Its main areas of intervention have focused on significantly lowering fuel consumption and CO2 emissions through the development of highly efficient hull designs, innovative propulsion systems and an extensive use of carbon fiber to decrease yacht weight.



A SAFE AND HEALTHY WORK ENVIRONMENT

The forerunning shipyard of Avigliana was the first of the company's Italian shipyards to obtain the ISO 45001 certification in 2011, attesting its rigorous abidance to all occupational health and safety requirements. Recognized as the most technologically-advanced shipyard in Europe, it has also led the nautical sector revolution in terms of being among the earliest adopters of the vacuum infusion process to drive resin into a laminate, avoiding styrene emissions and therefore guaranteeing its precious workers a healthier setting.

As of 2013, all the other Italian production sites have adapted to meet the necessary requirements to obtain the ISO 45001 certification.



GRANDE 27M



AZIMUT YACHTS

A GLOBALLY-CONNECTED DEALER AND SERVICE NETWORK

5 SHIPYARDS

6 DIRECT OFFICES

138 OFFICIAL DEALERS

80 COUNTRIES

The highly widespread commercial network put in place by Azimut Yachts, allows the company to offer a continuous presence to its ship owners, concretely curating their demands by meeting their most specific needs.

Find your Dealer →



THE LARGEST PRIVATE GROUP IN THE YACHTING WORLD

Azimut is part of the Azimut | Benetti Group, the biggest private player and shipbuilder in the nautical sector today. The Vitelli family, the founder and majority shareholder of the company, has been leading the way for over fifty years now, continuing to innovate through the Group's main yacht brands, Azimut and Benetti, while developing a variety of service brands to cater to the different demands of ship owners worldwide.



OUR SHIPYARDS MAKE US PROUD

Avigliana — Italy

HQ / SHIPYARD

Savona — Italy

DELIVERY CENTRE

Viareggio — Italy

SHIPYARD / STYLING LOUNGE

Fano — Italy

SHIPYARD

Itajaí — Brazil

SHIPYARD





CONCEPT & DESIGN: APART
PHOTOS: ALESSANDRO GUERRIERI, PAOLO PETRIGNANI

AZIMUT YACHTS THANKS:
ACHILLE SALVAGNI ARCHITETTI, ALDUS, FRETTE, SARTORIA
MATTEI, CATTINA, CALIBAN

OFFICIAL PARTNERS



AZIMUT | BENETTI SPA
VIA MARTIN LUTHER KING, 9
10051 AVIGLIANA, TORINO
ITALY

RELEASE 01.24

This brochure in no way constitutes a contract of sale for the boatyard's vessels to any person or company. All information contained herein, including but not limited to technical and performance data, illustrations, and drawings, is non-binding and for purposes of illustration only. The information in this brochure refers to the boatyard's standard motoryacht models available as of the date of publication. Technical and descriptive information is valid only to the extent that it pertains to the specific vessel that is the subject of a purchase. Contract terms are valid only to the extent that they are contained in a contract of sale. This document is based on information available at the time of publication. Despite efforts to ensure the greatest possible accuracy, the information contained herein may fail to cover all details, omit technical or commercial changes that may have been made subsequent to publication, describe features that are not present, and fail to envisage all circumstances that might occur. Any illustrations, photographs, diagrams and examples shown in this brochure are included solely for the purposes of illustrating the text. Due to the different features of each vessel, the boatyard assumes no liability for actual use based on the illustrated applications.

^ZIMUT

azimutyachts.com

