

^ZIMUT

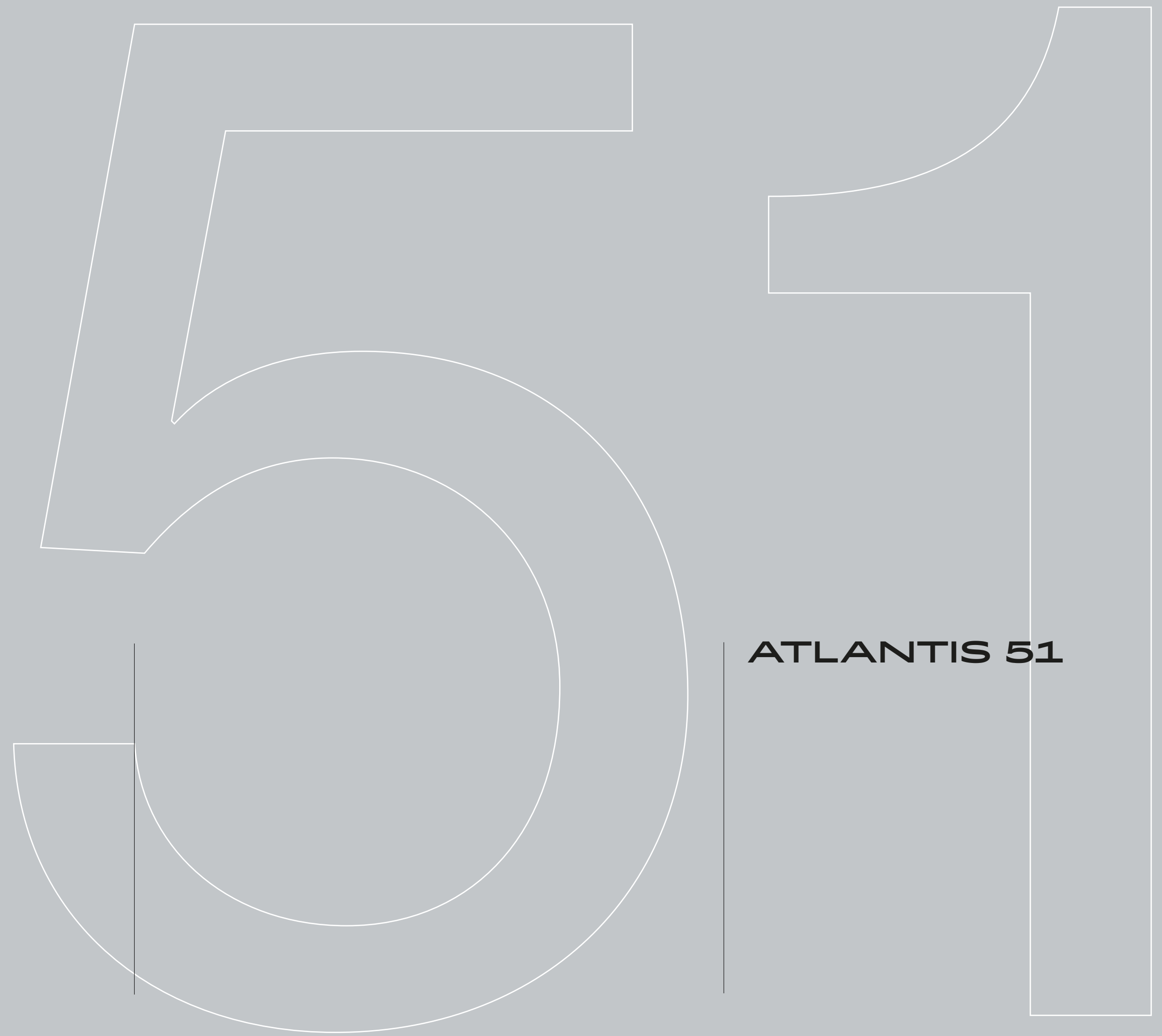

ATLANTIS 51



INDEX

01	THE DESIGN & LIFESTYLE ON BOARD	P04
02	ATLANTIS 51 SPEC SHEET	P26
03	THE ATLANTIS SERIES	P31
05	ABOUT AZIMUT	P33



A one-of-a-kind beauty, enrapturing,
that steals your breath away, leaving you
speechless. An extraordinary idea as the only
possible pathway, to get to where you want,
to explore, to go beyond.
The freedom of embracing the unknown, that
you know you'll love as a part of your very own
story. A thought that provokes your mind and
then inspires you to aim for the impossible,
making mistakes, yet being brave.
A magic je ne sais quoi that enchants and
intrigues you, moving you to feel more and to
sense uniqueness.

The choice to risk it all, the one that makes you
go for it, to impress yourself and all those who
are worth it.

Welcome to Azimut.

AZIMUT.
DARE TO AMAZE.



01

THE DESIGN & LIFESTYLE ON BOARD

ATLANTIS 51, SPORTS APPEAL WITH MAXIMUM LIVABILITY

Through forward-thinking solutions, the Atlantis 51 unites sporty heredity with likable livability, making room for the whole family to unwind in graceful harmony.

Convertible layouts accommodate social moments, allowing for convivial enthusiasm to take place in charming comfort. Generous and luminous interiors with flexible details perpetuate the optimistic sensation of this multi-purposeful environment, giving co-travelers the possibility to immerse themselves in a naturally pleasurable ambience.

Explore sporting DNA with ease on the Atlantis 51.





Welcome aboard, ladies and gentlemen.

Let us begin the tour.





SHE IS PURE EXCITEMENT



[Dark fashion plates almost merge with the windows, reborn to enhance lightness.]

The Atlantis 51 cuts a striking, eye-catching figure on the horizon. Her luscious living areas come without compromise, owing to the passionate design and engineering behind the project. Sleek lines and smooth, responsive handling give the impression of a sportive open yacht, even as she leads the class in comfort. She is recognized by her proportions, glazed surfaces and sleek profile, as dynamic and light on the water as she is elegant and graceful.

FREE TO CHARME

The open aft deck frames sunbathing for three in the middle of the sea. The bathing platform is just ahead, uniting the elements for a true open experience.





WHATEVER YOU NEED WHEREVER YOU ARE

The outdoor areas are furnished with thoughtful touches and advanced materials. The choice of Batyline fabric and Dryfill padding combines friendly, natural sensations with easy care.



EMBRACE THE FREEDOM OF AN OPEN-AIR LIFE STYLE

The cockpit lounge balances freedom and form across the indoor-outdoor deck. There is as much flexibility in the environment as in the gatherings to host, with the convertible, convivial, cushioned furniture leaving ample space for movement.







[The folding table and freestanding sofa seats can come together to accomodate a full complement of guests for meals.]



[A configurable chaise lounge sits aside the helm station with a protected front-row view to navigation, keeping the pilot.]



Now, let us discover the guest accomodations. Shall we?



AN ENTREATING ENCLAVE

The generous lower deck includes a full galley perfectly equipped, in addition to the less formal grilling setup in the cockpit bar.





Aspiring to create an airy and roomy environment below deck, the layout develops around a central square, constituted by the alignment of the galley with the lounge dinette to unify and expand the space.





[The master suite is wrapped with windows that flood in natural light. The wide foyer is entirely full-height, with room for a retractable vanity desk and plenty of storage.]





[The wide beam hosts a VIP amidships with twin beds that can be joined to form a queen-sized bed and leaves room for a generous third cabin.]



YOUR PERFECT STAY-CATION BETWEEN SKY AND SEA



The third cabin is designed for ergonomics with plenty of full height walking room and storage at hand. The wide window lets in plenty of natural light, just like the one in the day head, another thoughtful touch to brighten everyday life.





02

ATLANTIS 51 SPEC SHEET

GENERAL CHARACTERISTICS

LENGTH OVERALL	16,18 m	53’ 1”
BEAM MAX	4,55 m	14’ 11”
DRAFT	1,30 m	4’ 3”
DISPLACEMENT	22,3 t	49163 lb
ENGINES	2 x Volvo IPS 800 - 600 hp	
MAXIMUM SPEED	up to 32 kn	
CRUISING SPEED	up to 26 kn	
KEEL	Planing hull, aft deadrise: 13,6° - midship deadrise: 16,8°	
FUEL CAPACITY	1500 l	396 US Gls
WATER CAPACITY	450 l	119 US Gls
CABINS	3	
BERTHS	6	
HEAD COMPARTMENTS	2	
BUILDING MATERIAL	GRP	
EXTERIOR DESIGNER	Neo Design	
INTERIOR DESIGNER	Neo Design	
HULL DESIGNER	Azimut Benetti R&D Department	
BUILDER	Azimut Yachts	
CERTIFICATIONS	CE B; NMMA	

Last updated 08.2022
Please consult your dealer for the latest specifications.

UNI ISO 8666
The performance described applies to a vessel with standard configuration (standard equipment installed) and a clean hull, propellers, and rudder. It is also noted that the performance described was recorded under favourable sea and wind conditions (Beaufort scale index 1, Douglas scale index 1); different and worse sea conditions could significantly impact performance.

CE MARK
Given the continual evolution of technology, Azimut | Benetti S.p.A reserves the right to modify the technical specifications on its vessels at any time and without prior notice.

ABOVE VIEW

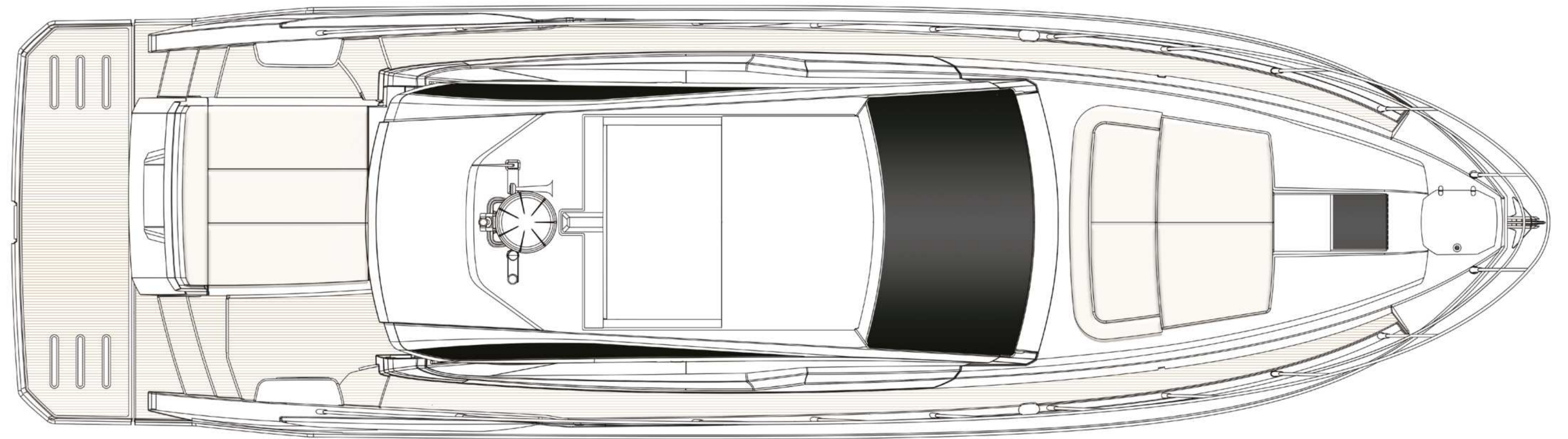

MAIN DECK

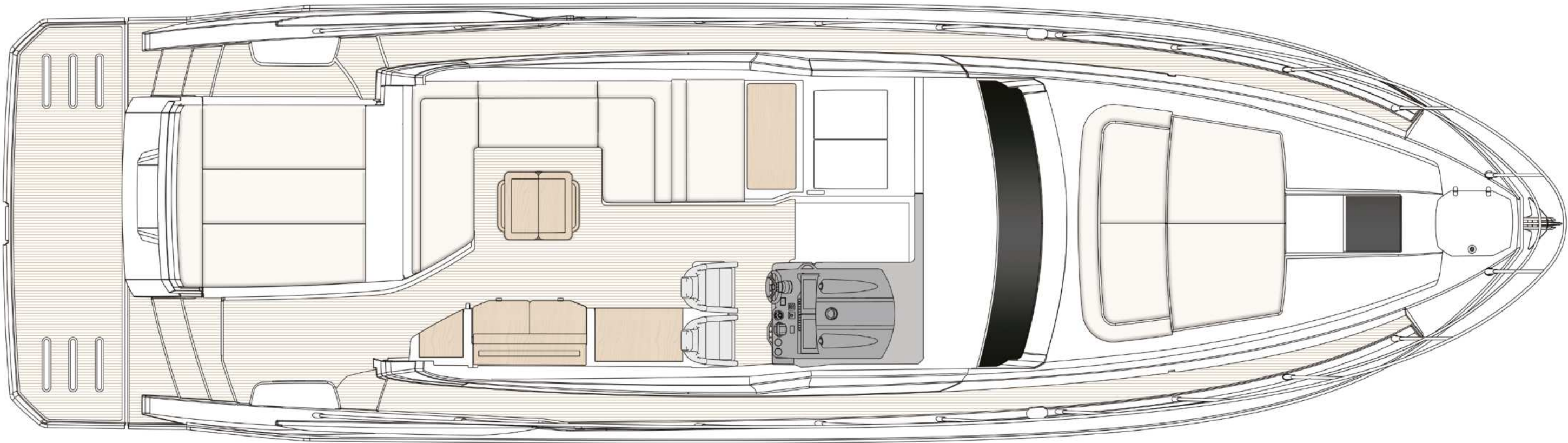

LOWER DECK

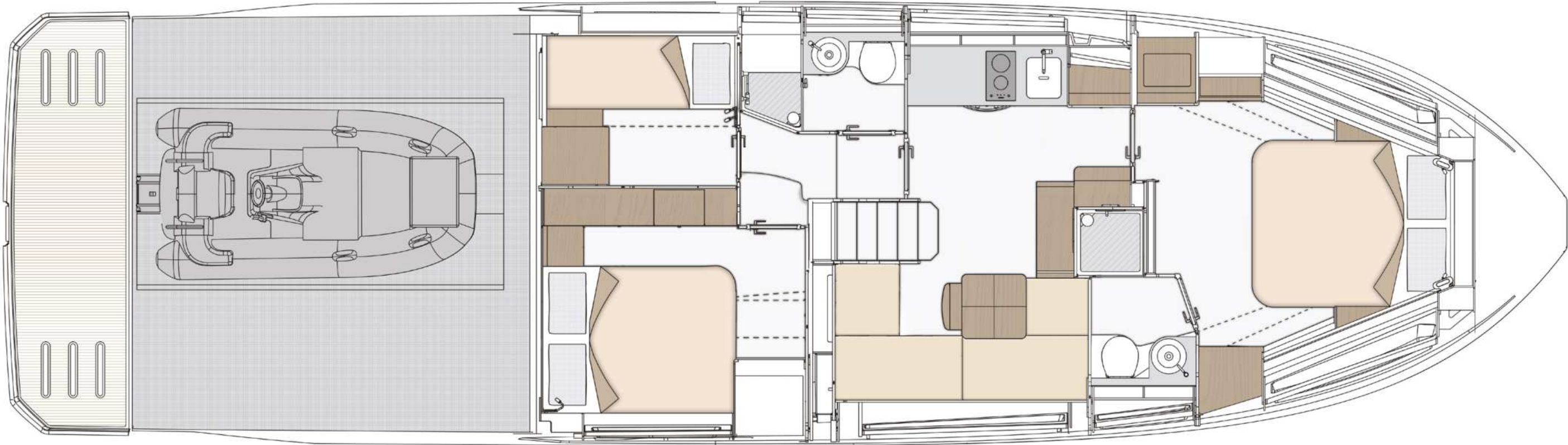

03

THE ATLANTIS SERIES

A THRILLING NAUTICAL NARRATIVE

The Azimut Atlantis Series unlocks a thrilling nautical narrative through the athletic aesthetics and genetics of a versatile sportive cruiser. Its personality designed for performance meets with technical finesse, allowing for ease of navigation while balancing beauty, safety and full functionality. Generous Italian-made interiors tailor to elegant tastes, opening up to the recreational possibilities of an indulgent but dynamic life at sea. Marvel at the harmony of sport and sublimity.

45
51



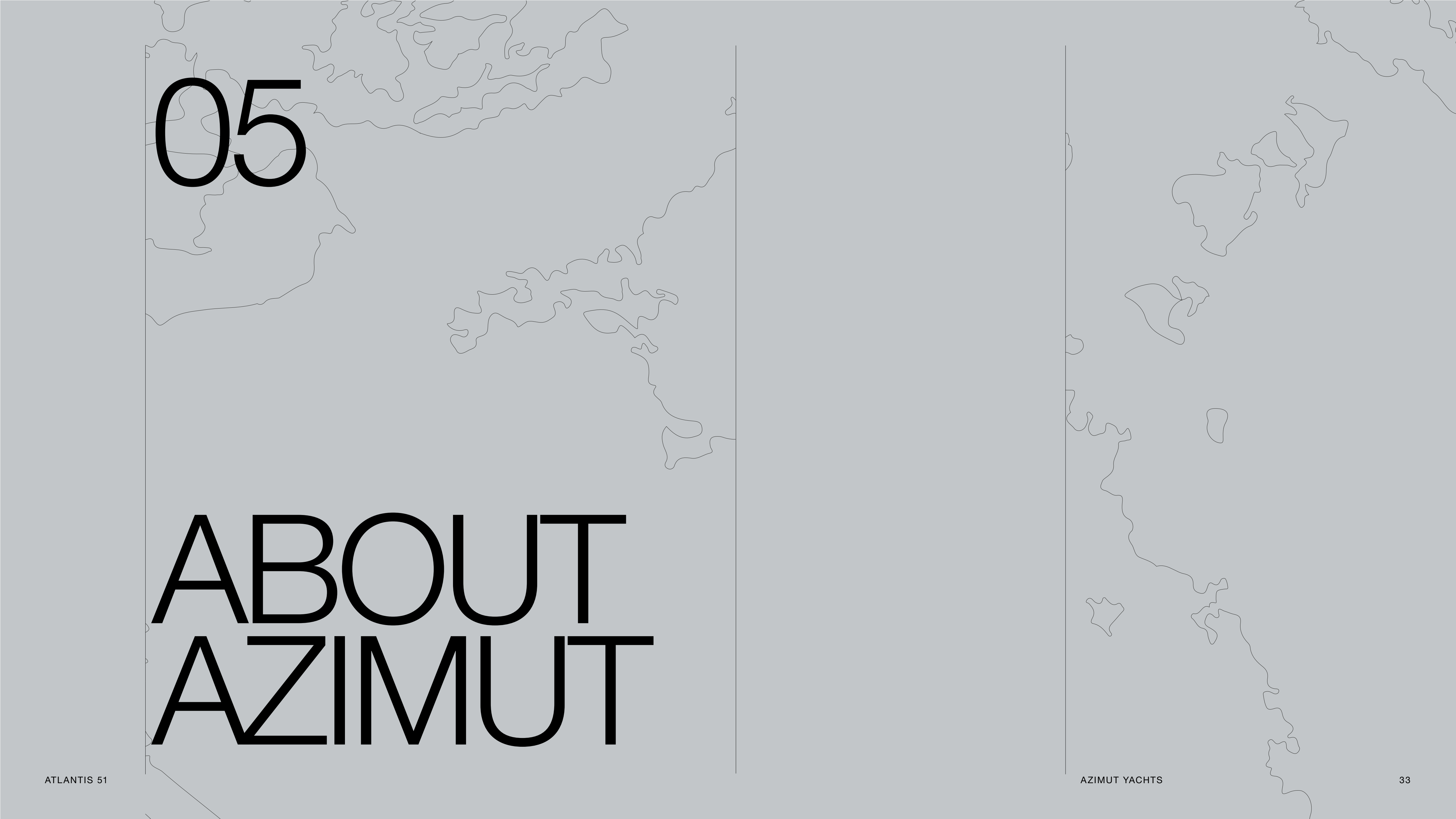

05

ABOUT AZIMUT



A FAMILY-MADE COMPANY CULTURE

An immense and personal passion for the sea. A clear and forward-facing attitude. A strong and relentless work ethic. Since 1969, Paolo Vitelli, the creative visionary founder and businessman behind Azimut, has been set on challenging the industry's status quo with a daring desire: bring to life an unexpected nautical experience, through yachts built to combine alluring aesthetics with construction expertise and impeccable technology.

An audacious mindset that has, over time, surprised and captivated the yachting sector, transforming Azimut into a bold and recognizable benchmark, and laying the foundation for the birth of the largest megayacht builder in the world, the Azimut | Benetti Group.

The international and management-based standing of the company today, is deeply nourished by the solid and memorable family heritage that has distinguished it from the beginning. A historically pioneering vision that enables it to continue thriving day after day, through ingenious inventions and long-term goals that look to the future with Paolo's daughter, Giovanna Vitelli.

A SUSTAINABLE VISION TODAY, FOR TOMORROW

An avant-garde vision and a strong emotional appeal have shaped the history of Azimut as a leader in the field of nautical innovation as well as its commitment to the creation of a sustainable-oriented and attentive company culture today.

An ambitious and personal touch that has allowed Azimut to grow and evolve on both levels, embracing the challenge of a future nurtured by an eco-conscious approach to boat construction and by an authentic focus and responsibility on human well-being.





OUR ECO-YACHTING PHILOSOPHY

The Azimut I Benetti Group has made tangible investments to guide the Technical as well as the R&D departments toward the construction of yachts with a diminished environmental impact. Its main areas of intervention have focused on significantly lowering fuel consumption and CO2 emissions through the development of highly efficient hull designs, innovative propulsion systems and an extensive use of carbon fiber to decrease yacht weight.



A SAFE AND HEALTHY WORK ENVIRONMENT

The forerunning shipyard of Avigliana was the first of the company's Italian shipyards to obtain the ISO 45001 certification in 2011, attesting its rigorous abidance to all occupational health and safety requirements. Recognized as the most technologically-advanced shipyard in Europe, it has also led the nautical sector revolution in terms of being among the earliest adopters of the vacuum infusion process to drive resin into a laminate, avoiding styrene emissions and therefore guaranteeing its precious workers a healthier setting.

As of 2013, all the other Italian production sites have adapted to meet the necessary requirements to obtain the ISO 45001 certification.



ATLANTIS 51



AZIMUT YACHTS

A GLOBALLY-CONNECTED DEALER AND SERVICE NETWORK

5 SHIPYARDS

6 DIRECT OFFICES

138 OFFICIAL DEALERS

80 COUNTRIES

The highly widespread commercial network put in place by Azimut Yachts, allows the company to offer a continuous presence to its ship owners, concretely curating their demands by meeting their most specific needs.

Find your Dealer →



THE LARGEST PRIVATE GROUP IN THE YACHTING WORLD

Azimut is part of the Azimut | Benetti Group, the biggest private player and shipbuilder in the nautical sector today. The Vitelli family, the founder and majority shareholder of the company, has been leading the way for over fifty years now, continuing to innovate through the Group's main yacht brands, Azimut and Benetti, while developing a variety of service brands to cater to the different demands of ship owners worldwide.



OUR SHIPYARDS MAKE US PROUD

Avigliana — Italy

HQ / SHIPYARD

Savona — Italy

DELIVERY CENTRE

Viareggio — Italy

SHIPYARD / STYLING LOUNGE

Fano — Italy

SHIPYARD

Itajaí — Brazil

SHIPYARD



CONCEPT & DESIGN: APART
PHOTOS: ALESSANDRO GUERRIERI, SARA MAGNI

AZIMUT YACHTS THANKS: APR LUXURY LINEN, CASAMANCE,
DEDAR, FRETTE, LA TAVOLA, MARIAFLORA, MARIO LUCA GIUSTI,
TOM DIXON

OFFICIAL PARTNERS



GARMIN

NAVICO
GROUP

Raymarine

SEAKEEPER

VOLVO
PENTA

AZIMUT | BENETTI SPA
VIA MARTIN LUTHER KING, 9
10051 AVIGLIANA, TORINO
ITALY

RELEASE 01.24

This brochure in no way constitutes a contract of sale for the boatyard’s vessels to any person or company. All information contained herein, including but not limited to technical and performance data, illustrations, and drawings, is non-binding and for purposes of illustration only. The information in this brochure refers to the boatyard’s standard motoryacht models available as of the date of publication. Technical and descriptive information is valid only to the extent that it pertains to the specific vessel that is the subject of a purchase. Contract terms are valid only to the extent that they are contained in a contract of sale. This document is based on information available at the time of publication. Despite efforts to ensure the greatest possible accuracy, the information contained herein may fail to cover all details, omit technical or commercial changes that may have been made subsequent to publication, describe features that are not present, and fail to envisage all circumstances that might occur. Any illustrations, photographs, diagrams and examples shown in this brochure are included solely for the purposes of illustrating the text. Due to the different features of each vessel, the boatyard assumes no liability for actual use based on the illustrated applications.

^ZIMUT

azimutyachts.com

